

**KEYWAY BROACH SETS**

**HIGH SPEED STEEL**

Broach sets come in a durable plastic case (Dura-Case) and include broaches, bushings, shims, lubrication and operation guides.

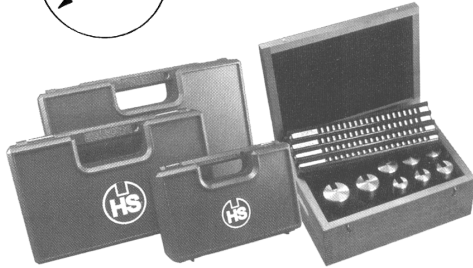
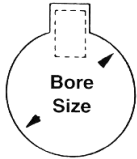

No. Of Combos	Type	Description	Dura Case	
			Part Number	Price Each
15	Standard Precision #1	<b>3 Broaches:</b> 1/16-I, 3/32-I, 1/8-I <b>5 Bushings:</b> 1/4-I, 5/16-I, 3/8-I, 7/16-I, 1/2-I	HS-15315	\$204.20
18	Standard Set C-1	<b>4 Broaches:</b> 1/8-II, 3/16-II, 1/4-III, 3/8-III <b>9 Bushings:</b> 1/2-II, 5/8-II, 3/4-III, 7/8-II, 1-III, 1-1/8-III, 1-1/4-III, 1-3/8-III, 1-1/2-III	HS-15318	\$356.90
18	Standard Set C-1A	<b>4 Broaches:</b> 1/8-II, 3/16-II, 1/4-III, 3/8-III <b>9 Bushings:</b> 9/16-II, 11/16-II, 13/16-II, 15/16-III, 1-1/16-III, 1-3/16-III, 1-5/16-III, 1-7/16-III, 1-9/16-III	HS-15319	\$356.90
15	Standard Set C-2	<b>3 Broaches:</b> 1/8-II, 3/16-III, 1/4-III <b>9 Bushings:</b> 9/16-II, 11/16-II, 13/16-II, 15/16-III, 1-1/16-III, 1-3/16-III, 1-5/16-III, 1-7/16-III, 1-9/16-III	HS-15320	\$302.55
14	Standard Set C-2A	<b>3 Broaches:</b> 1/8-II, 3/16-III, 1/4-III <b>9 Bushings:</b> 1/2-II, 5/8-II, 3/4-III, 7/8-II, 1-III, 1-1/8-III, 1-1/4-III, 1-3/8-III, 1-1/2-III	HS-15321	\$302.55
30	Standard Set C-10A	<b>3 Broaches:</b> 1/8-II, 3/16-III, 1/4-III <b>18 Bushings:</b> 1/2-II, 9/16-II, 5/8-II, 11/16-II, 3/4-III, 13/16-II, 7/8-II, 15/16-III, 1-III, 1-1/16-III, 1-1/8-III, 1-3/16-III, 1-1/4-III, 1-5/16-III, 1-3/8-III, 1-7/16-III, 1-1-1/2-III, 1-9/16-III	HS-15330	\$431.95
36	Standard Set C-10	<b>4 Broaches:</b> 1/8-II, 3/16-II, 1/4-III, 3/8-III <b>18 Bushings:</b> 1/2-II, 9/16-II, 5/8-II, 11/16-II, 3/4-III, 13/16-II, 7/8-II, 15/16-III, 1-III, 1-1/16-III, 1-1/8-III, 1-3/16-III, 1-1/4-III, 1-5/16-III, 1-3/8-III, 1-7/16-III, 1-1-1/2-III, 1-9/16-III	HS-15336	\$456.85

**KEYWAY BROACHES WITH SHIMS**  
**HIGH SPEED STEEL-AMERICAN STANDARD**

Used to cut keyways in machined round holes. Designed to be used with an arbor press or manually, it is suited for use in a variety of non-ferrous and ferrous materials.

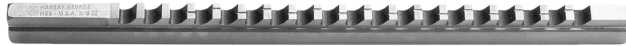

**FEATURES:**

- Tapered broach allows teeth to cut key way to proper depth
- Manufactured from high speed steel
- Ground and hardened bar with cutting teeth on the edges
- Replacement shims also available



Broach Size/Type	Keyway Width Tolerance	Dimensions	No. Of Shims	Part Number	Price Each
1/16 -I	.0625-.0635	1/8 X 5 1/4	0	HS-10104	\$53.75
3/32 -I	.0937-.0947	1/8 X 5 1/4	0	HS-10106	\$53.75
1/8 -I	.1252-.1262	1/8 X 5 1/4	1	HS-10108	\$53.75
3/32 -II	.0937-.0947	3/16 X 7	0	HS-10206	\$63.60
1/8 -II	.1252-.1262	3/16 X 7	1	HS-10208	\$63.60
5/32 -II	.1564-.1574	3/16 X 7	1	HS-10210	\$63.60
3/16 -II	.1877-.1887	3/16 X 7	1	HS-10212	\$63.60
3/16 -III	.1877-.1887	3/8 X 11 7/8	1	HS-10312	\$78.25
1/4 -III	.2502-.2512	3/8 X 11 7/8	1	HS-10316	\$78.25
5/16 -III	.3127-.3137	3/8 X 11 7/8	1	HS-10320	\$78.25
3/8 -III	.3755-.3765	3/8 X 11 7/8	2	HS-10324	\$78.25

Broach Size/Type	Keyway Width Tolerance	Dimensions	No. Of Shims	Part Number	Price Each
5/16 -IV	.3127-.3137	9/16 X 13 7/8	1	HS-10420	\$119.50
3/8 -IV	.3755-.3765	9/16 X 13 7/8	2	HS-10424	\$119.50
7/16 -IV	.4380-.4390	9/16 X 13 7/8	2	HS-10428	\$119.50
1/2 -IV	.5006-.5016	9/16 X 13 7/8	3	HS-10432	\$119.50
9/16 -IV	.5630-.5640	9/16 X 13 7/8	3	HS-10436	\$285.60
5/8 -V	.6260-.6270	3/4 X 15 1/4	4	HS-10540	\$194.95
3/4 -V	.7517-.7525	3/4 X 15 1/4	5	HS-10548	\$194.95
7/8 -VI	.8765-.8775	1 X 19 1/4	6	HS-10656	\$361.40
1" -VI	1.0015-1.0025	1 X 19 1/4	7	HS-10664	\$361.40
1 1/8	1.1260-1.1270	1 1/8 X 23	8	HS-10666	\$1,002.20
1 1/4	1.2510-1.2520	1 1/4 X 23	9	HS-10668	\$1,130.55

**ONE PASS KEYWAY BROACHES**  
**HIGH SPEED STEEL-AMERICAN STANDARD**

Used to cut keyways in machined round holes in a single pass. Designed to be used with an arbor press or manually, it is suited for use in a variety of non-ferrous and ferrous materials.

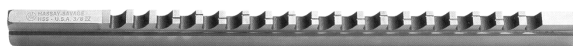

**FEATURES:**

- Tapered broach allows teeth to cut key way to proper depth
- Manufactured from high speed steel
- Ground and hardened bar with cutting teeth on the edges
- Replacement shims also available
- Also available in metric sizes

Broach Size/Type	Keyway Width Tolerance	Dimensions Inches	Min. Length of Cut	Max. Length of Cut	Part Number	Price Each
1/8 II	.1252-.1262	3/16 X 10 3/4	1/4	1 1/2	HS-10208COP	\$215.20
5/32 II	.1564-.1574	3/16 X 10 3/4	1/4	1 1/2	HS-10210COP	\$215.20
3/16 II	.1877-.1887	3/16 X 10 3/4	1/4	1 1/2	HS-10212COP	\$218.30
3/16 III	.1877-.1887	3/8 X 18 1/2	5/16	1 11/16	HS-10312COP	\$259.95
1/4 III	.2502-.2512	3/8 X 18 1/2	5/16	1 11/16	HS-10316COP	\$259.95
5/16 III	.3127-.3137	3/8 X 18 1/2	5/16	1 11/16	HS-10320COP	\$259.95
3/8 III	.3755-.3765	3/8 X 18 1/2	5/16	1 11/16	HS-10324COP	\$259.95

**EXTRA SHIMS**

**FOR STANDARD KEYWAY BROACHES**  
**HIGH SPEED STEEL-AMERICAN STANDARD**

Shims are designed to be placed between the bushing and the broach to allow the broach to cut deeper slots in the hole in succeeding passes.



Broach Size/Type	Thick.	Length x Width	Part Number	Price Each	Broach Size/Type	Thick.	Length x Width	Part Number	Price Each
1/8 I	.031	1 3/8 X 1/8	HS-30108	\$3.40	7/16 IV	.075	6 1/4 X 9/16	HS-30428	\$4.65
1/8 II	.031	1 7/8 X 3/16	HS-30208	\$3.40	1/2 IV	.062	6 1/4 X 9/16	HS-30432	\$4.65
5/32 II	.042	1 7/8 X 3/16	HS-30210	\$3.40	5/8 V	.062	6 3/4 X 3/4	HS-30540	\$4.65
3/16 II	.050	1 7/8 X 3/16	HS-30212	\$3.40	3/4 V	.062	6 3/4 X 3/4	HS-30548	\$4.65
3/16 III	.050	2 7/8 X 3/8	HS-30312	\$3.40	7/8 VI	.062	6 3/4 X 1	HS-30656	\$4.65
1/4 III	.062	2 7/8 X 3/8	HS-30316	\$3.40	1" VI	.062	6 3/4 X 1	HS-30664	\$4.65
5/16 III	.078	2 7/8 X 3/8	HS-30320	\$3.40	1.125	.062	7 X 1 1/8	HS-30740	\$7.80
3/8 III	.062	2 7/8 X 3/8	HS-30324	\$3.40	1.25	.062	7 X 1 1/4	HS-30750	\$7.80
5/16 IV	.078	6 1/4 X 9/16	HS-30420	\$4.65	1.375	.062	7 X 1 1/4	HS-30760	\$7.80
3/8 IV	.062	6 1/4 X 9/16	HS-30424	\$4.65	1.5	.062	7 X 1 1/4	HS-30770	\$7.80

Call Us Or Visit Our Website For Our Complete Selection!

LATHE CHUCKS  
LIVE CENTERS

VICE JAWS  
VICE ACCESSORIES

STRAIGHT SHANK  
COLLET HOLDERS

TAP HOLDERS  
DRILL CHUCKS

CARBIDE INSERTS  
THREADING/GROOVING

CUTTING TOOLS  
MACHINERY

PRECISION TOOLS  
DEBURRING

COOLANT/FLUIDS  
TOOL STORAGE

# BROACHES

## KEYWAY BUSHINGS KNURLED COLLAR & PLAIN TYPE

Designed for use with standard keyway broaches for cutting keyways in machined holes. Keyway bushings act as a guide to guide the keyway broach through the hole.

**Plain Type:** Used with Type IV & V broaches  
**Knurled Collar Type:** Designed for use with Type I, II & III broaches

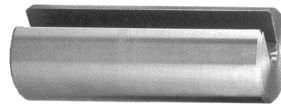

Plain Type Bushing



Collar Bushing

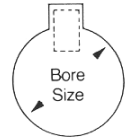

### I Collared Bushings for I Broaches

Dia/Type	Length	Part Number	Price Each
1/4 I	1 1/8	HS-20116	\$12.95
5/16 I	1 1/8	HS-20120	\$12.95
3/8 I	1 1/8	HS-20124	\$12.95
7/16 I	1 1/8	HS-20128	\$12.95
1/2 I	1 1/8	HS-20132	\$12.95

### II Collared Bushings for II Broaches

Dia/Type	Length	Part Number	Price Each
1/2 II	1 11/16	HS-20232	\$11.40
9/16 II	1 11/16	HS-20236	\$11.40
5/8 II	1 11/16	HS-20240	\$11.40
11/16 II	1 11/16	HS-20244	\$11.40
3/4 II	1 11/16	HS-20248	\$11.40
13/16 II	1 11/16	HS-20252	\$11.40
7/8 II	1 11/16	HS-20256	\$11.40

### III Collared Bushings for III Broaches

Dia/Type	Length	Part Number	Price Each
3/4 III	2 1/2	HS-20348	\$15.20
13/16 III	2 1/2	HS-20352	\$15.20
7/8 III	2 1/2	HS-20356	\$15.20
15/16 III	2 1/2	HS-20360	\$15.20
1" III	2 1/2	HS-20364	\$15.20

### III Collared Bushings for III Broaches

Dia/Type	Length	Part Number	Price Each
1 1/16 III	2 1/2	HS-20368	\$15.20
1 1/8 III	2 1/2	HS-20372	\$15.20
1 3/16 III	2 1/2	HS-20376	\$18.40
1 1/4 III	2 1/2	HS-20380	\$18.40
1 5/16 III	2 1/2	HS-20384	\$18.40
1 3/8 III	2 1/2	HS-20388	\$18.40
1 7/16 III	2 1/2	HS-20392	\$18.40
1 1/2 III	2 1/2	HS-20396	\$18.40
1 9/16 III	2 1/2	HS-20400	\$18.40

### IV Plain Bushings for IV Broaches

Dia/Type	Length	Part Number	Price Each
1 7/16	4	HS-21492	\$18.40
1 1/2	4	HS-21496	\$18.40
1 9/16	4	HS-21500	\$18.40
1 5/8	4	HS-21504	\$18.40
1 11/16	4	HS-21508	\$25.70
1 3/4	4	HS-21512	\$25.70
1 13/16	5	HS-21516	\$25.70
1 7/8	5	HS-21520	\$25.70
1 15/16	5	HS-21524	\$28.10

### IV Plain Bushings for IV Broaches

Dia/Type	Length	Part Number	Price Each
2"	5	HS-21528	\$28.10
2 1/16	5	HS-21532	\$28.10
2 1/8	5	HS-21536	\$28.10
2 3/16	5	HS-21540	\$28.10
2 1/4	5	HS-21544	\$37.50
2 5/16	5	HS-21548	\$37.50
2 3/8	6	HS-21552	\$37.50
2 7/16	6	HS-21556	\$37.50
2 1/2	6	HS-21560	\$47.70
2 9/16	6	HS-21564	\$47.70
2 5/8	6	HS-21568	\$47.70
2 11/16	6	HS-21572	\$47.70
2 3/4	6	HS-21576	\$47.70
2 13/16	6	HS-21580	\$47.70
2 7/8	6	HS-21584	\$47.70
2 15/16	6	HS-21588	\$47.70
3	6	HS-21592	\$47.70

Additional Sizes Available.

## KEYWAY BROACH SETS

Heavy Duty, High Speed Steel

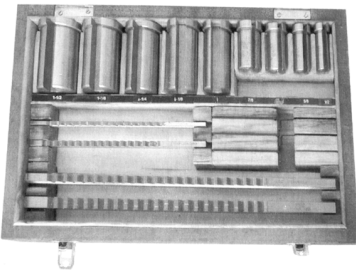

- High speed steel
- Complete with wood case
- **30 piece set** includes 5 broaches, 18 collared bushings and 7 shims for 47 keyway combinations.
- **9 piece set** includes 3 broaches, 5 collared bushings and 1 shim for 15 keyway combinations



No. Of Combos	Type	Description	Part Number	Price Each
15	Standard Style A	<b>3 Broaches:</b> 1/16, 3/32, 1/8 <b>5 Bushings:</b> 1/4, 5/16, 3/8, 7/16, 1/2 (includes shim)	A-2006-0051	\$155.00
47	Standard Style B/C	<b>5 Broaches:</b> 1/8-B, 3/16-B, 1/4-C, 5/16-C, 3/8-C <b>18 Bushings:</b> 1/2-B, 9/16-B, 5/8-B, 11/16-B, 3/4-B, 13/16-B, 7/8-B, 15/16-C, 1"-C, 1-1/16-C, 1-1/8-C, 1-3/16-C, 1-1/4-C, 1-5/16-C, 1-3/8-C, 1-7/16-C, 1-1/2-C, 1-9/16-C (includes 7 shims)	A-2006-0056	\$550.00

## ARBOR PRESSES

The Palmgren arbor press delivers the heavy force needed for riveting, squeezing, punching, bending, and other pressing applications with sturdy, cast-iron construction. Removable machined steel anvil provides accurate work support in four slot positions. Rugged steel ram is driven by a machined pinion. Punches or tools may be added to the end of the ram with the aid of a magnetic insert. Base drilled for mounting on a bench or pedestal. PALM-61101 is equipped with a handwheel to perform light and quick press work.

The Arbor Press Stand provides a sturdy base and optimal height for easy operation. It has a slot on the top for pieces which need to extend below the base of the press table. Stand comes with built-in cup for catching expressed pieces. Base and top are cast iron; body of welded steel. Fits all 2-4 ton presses.



Arbor Press Stand  
PALM-70103



Force Ton	Swing	Anvil Dia.	Max Work Hgt.	Ram Dim.	Height	Base Dimension	Wgt	Part Number	Price Each
0.5	7-1/2"	3-3/8"	4-1/2"	3/4" x 3/4"	9-3/8"	5-1/8" x 9-3/8"	22 lbs	PALM-61051	\$78.60
1	8"	4-7/16"	6-1/8"	1" x 1"	11-1/8"	6-5/16 x 10-3/4"	27 lbs	PALM-61101	\$115.30
2	11-7/8"	6-5/8"	8"	1-1/4" x 1-1/4"	15-1/8"	11-1/8 x 16"	64 lbs	PALM-61201	\$236.75
3	12-1/2"	6-5/8"	12-5/8"	1-1/2" x 1-1/2"	21"	7-7/8 x 17-7/8"	102 lbs	PALM-61301	\$369.40

### Arbor Press Stand

Top Dimension	Base Dimension	Height	Wgt	Part Number	Price Each
11-13/16" x 22-1/16"	11-13/16" x 22-1/4"	33-13/16"	100 lbs	PALM-70103	\$288.10

Call Us Today For All Of Your Machine Tool Needs!

## STANDARD HEXAGON PUSH BROACHES HIGH SPEED STEEL



Used to cut hexagonal shaped holes in machined round holes. Designed to allow broach to start in a plain round hole and cut a precisely shaped hexagonal hole in a single pass. Designed to be used with an arbor press or manually, it is suited for use in a variety of non-ferrous and ferrous materials.

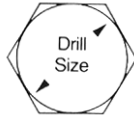

### FEATURES:

- Each tooth is progressively larger and cuts slightly deeper than the previous tooth
- Manufactured from high speed steel
- Ground and hardened bar with cutting teeth on the edges
- Also available in metric sizes

Hex Size	Tolerance	Pilot Dia	Drill Size	Broach Length	Min LOC	Max LOC	Part Number	Price Each
1/8	.1255-.1260	.1245	1/8	4 5/8	3/16	3/8	HS-12008	\$133.10
5/32	.1565-.1570	.1557	5/32	5 1/2	1/4	1/2	HS-12010	\$150.85
3/16	.1880-.1890	.1870	3/16	5 9/16	1/4	5/8	HS-12012	\$140.05
7/32	.2190-.2200	.2182	7/32	6	1/4	3/4	HS-12014	\$166.25
1/4	.2505-.2515	.2495	1/4	6 1/2	1/4	3/4	HS-12016	\$140.05
9/32	.2815-.2825	.2807	9/32	7 3/4	3/8	1	HS-12018	\$173.30
5/16	.3130-.3140	.3120	5/16	8 1/4	3/8	1	HS-12020	\$146.45
11/32	.3440-.3450	.3432	11/32	8 1/4	3/8	1 1/4	HS-12022	\$213.20
3/8	.3755-.3765	.3745	3/8	9	3/8	1 1/4	HS-12024	\$171.30
13/32	.4065-.4075	.4057	13/32	10	1/2	1 3/8	HS-12026	\$255.10
7/16	.4385-.4395	.4370	7/16	10 3/4	1/2	1 3/8	HS-12028	\$216.60
15/32	.4690-.4700	.4682	15/32	12 3/8	1/2	1 3/8	HS-12030	\$305.75
1/2	.5005-.5015	.4995	1/2	12 1/2	1/2	1 3/8	HS-12032	\$253.40
9/16	.5630-.5640	.5620	9/16	14 1/4	1/2	1 1/2	HS-12036	\$304.05
5/8	.6260-.6270	.6245	5/8	16 7/8	5/8	1 5/8	HS-12040	\$350.15
11/16	.6880-.6890	.6870	11/16	17	5/8	1 5/8	HS-12044	\$385.80
3/4	.7510-.7520	.7495	3/4	17 7/8	5/8	1 5/8	HS-12048	\$406.65
7/8	.8755-.8765	.8745	7/8	18 7/8	5/8	1 5/8	HS-12056	\$640.90
1"	1.0020-1.0030	.9995	1	19 7/8	5/8	1 5/8	HS-12064	\$671.55



## INTERNAL HEX & SQUARE BROACHES HIGH SPEED STEEL

### FEATURES:

- Also referred to as "wobble," "blind hole," "punch" and "rotary" broaches
- For use with screw machines, CNC turning machines and presses
- Also available in special forms- torx, octagons, splines- please call for more information
- For Rotary Broach Holders, please see the following page

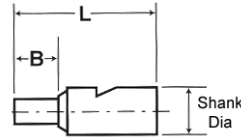
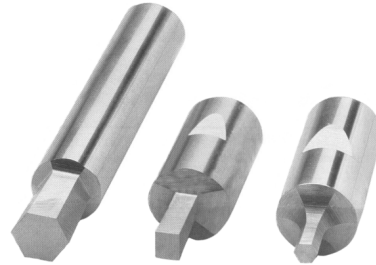

### HEXAGONAL PUNCH BROACHES .315 SHANK

Shank Dia	Hex Size	DOC B	OAL L	Part Number	Price Each
.315	.051	5/64	1-1/4	HS-66002	\$57.30
	1/16	3/32	1-1/4	HS-66004	\$57.30
	5/64	7/64	1-1/4	HS-66005	\$57.30
	3/32	9/64	1-1/4	HS-66006	\$57.30
	7/64	5/32	1-1/4	HS-66007	\$57.30
	1/8	3/16	1-1/4	HS-66008	\$57.30
	9/64	7/32	1-1/4	HS-66009	\$57.30
	5/32	1/4	1-1/4	HS-66010	\$57.30
	3/16	9/32	1-1/4	HS-66012	\$57.30
	7/32	11/32	1-1/4	HS-66014	\$57.30
	1/4	3/8	1-1/4	HS-66016	\$57.30
	9/32	3/8	1-1/2	HS-66018	\$75.60
	5/16	3/8	1-1/2	HS-66020	\$75.60
	11/32	7/16	1-1/2	HS-66022	\$75.60
	3/8	1/2	1-1/2	HS-66024	\$78.80
	13/32	1/2	1-1/2	HS-66026	\$78.80
	7/16	1/2	1-1/2	HS-66028	\$78.80
	15/32	1/2	1-1/2	HS-66030	\$78.80
1/2	1/2	1-1/2	HS-66032	\$78.80	

### HEXAGONAL PUNCH BROACHES .500 SHANK

Shank Dia	Hex Size	DOC B	OAL L	Part Number	Price Each
.500	1/4	3/8	1-1/2	HS-66116	\$67.40
	9/32	7/16	1-1/2	HS-66118	\$67.40
	5/16	1/2	1-1/2	HS-66120	\$67.40
	11/32	9/16	1-1/2	HS-66122	\$67.40
	3/8	9/16	1-1/2	HS-66124	\$67.40
	13/32	5/8	2	HS-66126	\$89.70
	7/16	5/8	2	HS-66128	\$89.70
	15/32	5/8	2	HS-66130	\$89.70
	1/2	5/8	2	HS-66132	\$89.70
	9/16	5/8	2	HS-66136	\$92.25
	5/8	3/4	2	HS-66140	\$94.40
	11/16	7/8	2	HS-66144	\$97.40
3/4	7/8	2	HS-66148	\$99.25	

### SQUARE PUNCH BROACHES .315 SHANK

Shank Dia	Hex Size	DOC B	OAL L	Part Number	Price Each
.315	1/16	1/8	1-1/4	HS-68004	\$57.30
	3/32	9/64	1-1/4	HS-68006	\$57.30
	1/8	3/16	1-1/4	HS-68008	\$57.30
	5/32	1/4	1-1/4	HS-68010	\$57.30
	3/16	9/32	1-1/4	HS-68012	\$57.30
	7/32	11/32	1-1/4	HS-68014	\$57.30
	1/4	3/8	1-1/2	HS-68016	\$77.90
	9/32	3/8	1-1/2	HS-68018	\$77.90
	5/16	3/8	1-1/2	HS-68020	\$77.90
	11/32	3/8	1-1/2	HS-68022	\$79.05
	3/8	3/8	1-1/2	HS-68024	\$79.05

### SQUARE PUNCH BROACHES .500 SHANK

Shank Dia	Hex Size	DOC B	OAL L	Part Number	Price Each
.500	3/32	9/64	1-1/2	HS-68106	\$67.40
	1/8	3/16	1-1/2	HS-68108	\$67.40
	5/32	1/4	1-1/2	HS-68110	\$67.40
	3/16	9/32	1-1/2	HS-68112	\$67.40
	7/32	11/32	1-1/2	HS-68114	\$67.40
	1/4	3/8	1-1/2	HS-68116	\$67.40
	9/32	7/16	1-1/2	HS-68118	\$67.40
	5/16	1/2	1-1/2	HS-68120	\$67.40
	11/32	9/16	1-1/2	HS-68122	\$94.60
	3/8	5/8	2	HS-68124	\$94.60
	7/16	5/8	2	HS-68128	\$94.60
	1/2	5/8	2	HS-68132	\$94.60
9/16	3/4	2	HS-68136	\$99.25	
5/8	7/8	2	HS-68140	\$99.25	

### HEXAGONAL PUNCH BROACHES .500 SHANK

Shank Dia	Hex Size	DOC B	OAL L	Part Number	Price Each
.500	3/32	9/64	1-1/2	HS-66106	\$67.40
	7/64	5/32	1-1/2	HS-66107	\$67.40
	1/8	3/16	1-1/2	HS-66108	\$67.40
	9/64	7/32	1-1/2	HS-66109	\$67.40
	5/32	1/4	1-1/2	HS-66110	\$67.40
	3/16	9/32	1-1/2	HS-66112	\$67.40
	7/32	9/32	1-1/2	HS-66114	\$67.40

### HEXAGONAL PUNCH BROACHES .750 SHANK

Shank Dia	Hex Size	DOC B	OAL L	Part Number	Price Each
.750	3/8	1/2	2-1/2	HS-66524	\$89.70
	7/16	1/2	2-1/2	HS-66528	\$89.70
	1/2	1/2	2-1/2	HS-66532	\$89.70
	9/16	3/4	2-1/2	HS-66536	\$124.40
	5/8	3/4	2-1/2	HS-66540	\$124.40
	3/4	7/8	2-3/4	HS-66548	\$131.15
	7/8	7/8	2-3/4	HS-66556	\$131.15
	1	7/8	2-3/4	HS-66564	\$140.70



**Rotary Broach Holders Also Available!**

Call Us Or Visit Our Website For Our Complete Selection!