

CAT-40 V-FLANGE TOOLHOLDERS

END MILL HOLDERS

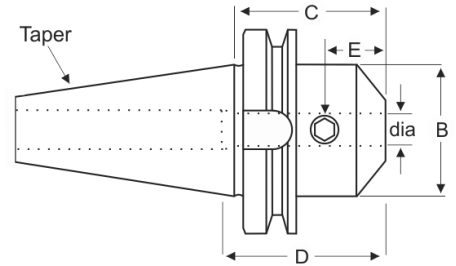

- Large selection of end mill holders from nationally recognized manufacturers
- **Kingston Toolholders** are balanced to 15,000 RPM @ g6.3
- **Spin Tru Toolholders** are balanced to 20,000 RPM @ g2.5
- Full line available from all vendors listed-please call for information



CAT 40		ENDMILL HOLDERS									
Dia	C Proj.	B OD	D Max Socket Depth	E	Brand	Part Number	Price Each	Set Screw Size	Set Screw Part Number	MAX RPM Balanced Up to	Code
1/8"	1.38	0.68	-	-	Kingston	C40-01EM138-K	\$49.95	10-32	SSE-10-32-250	15,000G6.3	F
		0.68	-	-	Spin Tru	C40-01EM138-KB	\$69.99	10-32	SSE-10-32-250	20,000G2.5	D
	1.75	-	-	-	Kingston	C40-01EM175-K	\$53.85	10-32	SSE-10-32-250	15,000G6.3	F
		0.69	3.00	0.19	Parlec*	C40-01EM175-P	\$106.20	M10-32	SSE-10-32-250	20,000G2.5	D
	2.36	0.75	0.63	-	Lyndex	C40-01EM236-L	\$115.66	6-32	SSE-06-32-250	-	A
	2.50	-	-	-	Kingston	C40-01EM250-K	\$53.85	10-32	SSE-10-32-250	15,000G6.3	F
		0.69	3.80	0.19	Parlec*	C40-01EM250-KB	\$69.99	10-32	SSE-10-32-250	20,000G2.5	D
	3.00	-	-	-	Kingston	C40-01EM300-K	\$53.85	10-32	SSE-10-32-250	15,000G6.3	F
0.68		-	-	Spin Tru	C40-01EM300-KB	\$69.99	10-32	SSE-10-32-250	20,000G2.5	D	
4.00	1.00	3.00	0.19	Parlec*	C40-01EM300-P	\$125.55	M10-32	SSE-10-32-250	-	A	
	0.75	0.63	-	Lyndex	C40-01EM400-L	\$128.73	6-32(1)	SSE-06-32-250	-	B	
3/16"	1.38	0.69	-	-	Kingston	C40-18EM138-K	\$49.95	10-32	SSE-10-32-250	15,000G6.3	F
		0.69	-	-	Spin Tru	C40-18EM138-KB	\$69.99	10-32	SSE-10-32-250	20,000G2.5	D
	1.75	-	-	-	Kingston	C40-18EM175-K	\$53.85	10-32	SSE-10-32-250	15,000G6.3	F
		0.69	3.00	0.44	Parlec*	C40-18EM175-P	\$106.20	M10-32(1)	SSE-10-32-250	20,000G2.5	D
	2.50	0.69	-	-	Kingston	C40-18EM250-K	\$53.85	10-32	SSE-10-32-250	15,000G6.3	F
		0.69	-	-	Spin Tru	C40-18EM250-KB	\$69.99	10-32	SSE-10-32-250	20,000G2.5	D
	3.00	0.75	-	-	Techniks	C40-18EM250-T	\$78.30	1/4"-28	SSE-25-28-313	-	B
		0.75	0.86	-	Lyndex	C40-18EM250-L	\$115.66	8-32(1)	SSE-08-32-250	-	B
4.00	0.69	-	-	Spin Tru	C40-18EM300-KB	\$70.50	10-32	SSE-10-32-250	20,000G2.5	D	
	1.00	3.00	0.44	Parlec*	C40-18EM300-P	\$131.40	M10-32(1)	SSE-10-32-250	-	A	
1/4"	1.38	0.75	0.86	-	Lyndex	C40-18EM400-L	\$128.73	8-32(1)	SSE-08-32-250	-	B
		-	-	-	Kingston	C40-18EM600-K	\$60.45	10-32	SSE-10-32-250	15,000G6.3	F
	1.75	-	-	-	Spin Tru	C40-18EM600-KB	\$74.47	10-32	SSE-10-32-250	20,000G2.5	D
		1.00	3.80	0.44	Parlec*	C40-18EM600-P	\$156.60	M10-32(1)	SSE-10-32-250	-	A
	2.50	1.00	-	-	Kingston	C40-25EM138-K	\$49.95	1/4"-20	SSE-25-20-250	15,000G6.3	F
		1.00	2.50	0.75	Spin Tru	C40-25EM138-KB	\$69.99	1/4"-20	SSE-25-20-250	20,000G2.5	D
	3.00	0.79	1.18	-	Lyndex	C40-25EM138-L	\$121.36	1/4"-28(1)	SSE-25-28-250	-	B
		-	-	-	Kingston	C40-25EM175-K	\$53.85	1/4"-20	SSE-25-20-250	15,000G6.3	F
4.00	-	-	-	Spin Tru	C40-25EM175-KB	\$69.99	1/4"-20	SSE-25-20-250	20,000G2.5	D	
	0.88	3.00	0.44	Parlec*	C40-25EM175-P	\$94.50	1/4"-28(1)	SSE-25-28-250	-	A	
2.50	1.00	-	-	Kingston	C40-25EM250-K	\$53.85	1/4"-20	SSE-25-20-250	15,000G6.3	F	
	1.00	4.21	0.75	Spin Tru	C40-25EM250-KB	\$69.99	1/4"-20	SSE-25-20-250	20,000G2.5	D	
3.00	0.88	3.80	0.44	Parlec*	C40-25EM250-P	\$94.50	1/4"-28(1)	SSE-25-28-250(2)	-	B	
	0.79	1.10	-	Lyndex	C40-25EM250-L	\$107.11	1/4"-28(1)	SSE-25-28-250	-	B	
4.00	0.79	-	-	Sowa	C40-25EM250-GB	\$90.72	1/4"-28	SSE-25-28-250	20,000	C	
	1.00	-	-	Spin Tru	C40-25EM300-KB	\$70.50	1/4"-20	SSE-25-20-250	20,000G2.5	D	
6.00	1.00	3	0.44	Parlec*	C40-25EM300-P	\$94.50	1/4"-28(1)	SSE-25-28-250(2)	-	A	
	-	-	-	Spin Tru	C40-25EM400-KB	\$73.02	1/4"-20	SSE-25-20-250	20,000G2.5	D	
6.00	0.79	1.10	-	Lyndex	C40-25EM400-L	\$128.73	1/4"-28(1)	SSE-25-28-250	-	B	
	-	-	-	Kingston	C40-25EM600-K	\$60.45	1/4"-20	SSE-25-20-250	15,000G6.3	F	
6.00	-	-	-	Spin Tru	C40-25EM600-KB	\$74.47	1/4"-20	SSE-25-20-250	20,000G2.5	D	
	1.00	3.8	0.44	Parlec*	C40-25EM600-P	\$117.90	1/4"-28(1)	SSE-25-28-250	-	A	

Call Us Today For All Of Your Machine Tool Needs!

CAT-40 V-FLANGE TOOLHOLDERS

END MILL HOLDERS



- Large selection of end mill holders from nationally recognized manufacturers
- **Kingston Toolholders** are balanced to 15,000 RPM @ g6.3
- **Spin Tru Toolholders** are balanced to 20,000 RPM @ g2.5
- Full line available from all vendors listed-please call for information

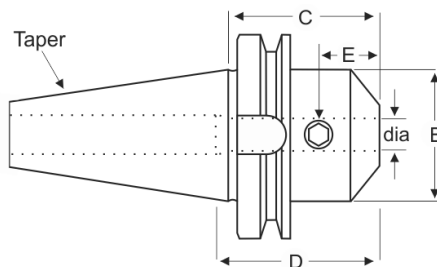

CAT 40 ENDMILL HOLDERS

Dia	C Proj.	B OD	D Max Socket Depth	E	Brand	Part Number	Price Each	Set Screw Size	Set Screw Part Number	MAX RPM Balanced Up to	Code
5/16"	1.38	1.00	-	-	Kingston	C40-31EM138-K	\$49.95	5/16"-18	SSE-31-18-313	15,000G6.3	F
		1.00	2.50	0.75	Spin Tru	C40-31EM138-KB	\$69.99	5/16"-18	SSE-31-18-313	20,000G2.5	D
		0.87	1.34	-	Lyndex	C40-31EM138-L	\$131.10	5/16"-24(1)	SSE-31-24-250	-	B
	1.75	-	-	-	Kingston	C40-31EM175-K	\$53.85	5/16"-18	SSE-31-18-313	15,000G6.3	F
		1.00	3.00	0.44	Parlec*	C40-31EM175-P	\$100.35	1/4"-28(1)	SSE-25-28-250	-	A
		1.00	-	-	Kingston	C40-31EM250-K	\$53.85	5/16"-18	SSE-31-18-313	15,000G6.3	F
	2.50	1.00	4.21	0.73	Spin Tru	C40-31EM250-KB	\$69.99	5/16"-18	SSE-31-18-313	20,000G2.5	D
		1.00	3.80	0.44	Parlec*	C40-31EM250-P	\$95.40	1/4"-28(1)	SSE-25-28-250(2)	-	A
		0.87	1.26	-	Lyndex	C40-31EM250-L	\$120.41	5/16"-24(1)	SSE-31-24-250	-	B
		0.87	-	-	Sowa	C40-31EM250-GB	\$98.82	5/16"-24	SSE-31-24-250	20,000	C
	3.00	0.98	-	-	Techniks	C40-31EM300-T	\$78.30	5/16"-24	SSE-31-24-313	-	B
	4.00	-	-	-	Spin Tru	C40-31EM400-KB	\$73.02	5/16"-18	SSE-31-18-313	20,000G2.5	D
0.87		1.26	-	Lyndex	C40-31EM400-L	\$141.08	5/16"-24(1)	SSE-31-24-250	-	B	
0.87		-	-	Sowa	C40-31EM400-GB	\$87.03	5/16"-24	SSE-31-24-250	20,000	C	
6.00	1.00	3.80	0.44	Parlec*	C40-31EM600-P	\$100.35	1/4"-28(1)	SSE-25-28-250	-	A	
3/8"	1.38	1.25	-	-	Kingston	C40-37EM138-K	\$49.95	3/8"-16	SSE-38-16-313	15,000G6.3	F
		1.00	1.80	0.75	Spin Tru	C40-37EM138-KB	\$69.99	3/8"-16	SSE-38-16-313	20,000G2.5	D
		1.00	1.34	-	Lyndex	C40-37EM138-L	\$121.36	3/8"-24(1)	SSE-37-24-313	-	B
	1.75	-	-	-	Kingston	C40-37EM175-K	\$53.85	3/8"-16	SSE-38-16-313	15,000G6.3	F
		1.00	3.00	0.75	Parlec*	C40-37EM175-P	\$95.40	3/8"-24(1)	SSE-38-24-313	-	A
		1.25	-	-	Kingston	C40-37EM250-K	\$53.85	3/8"-16	SSE-38-16-313	15,000G6.3	F
	2.50	1.00	4.21	0.75	Spin Tru	C40-37EM250-KB	\$69.99	3/8"-16	SSE-38-16-313	20,000G2.5	D
		1.00	3.80	0.75	Parlec*	C40-37EM250-P	\$95.40	3/8"-24(1)	SSE-38-24-313(2)	-	B
		1.00	-	-	Sowa	C40-37EM250-GB	\$98.82	3/8"-24	SSE-38-24-313	20,000	C
		1.00	-	-	Techniks	C40-37EM300-T	\$78.30	3/8"-24	SSE-38-24-375	-	B
	4.00	-	-	-	Spin Tru	C40-37EM400-KB	\$73.02	3/8"-16	SSE-38-16-313	20,000G2.5	D
	4.50	1.00	3.80	0.75	Parlec*	C40-37EM450-P	\$130.50	3/8"-24(1)	SSE-38-24-313	-	A
5.00	-	-	-	Spin Tru	C40-37EM500-KB	\$73.02	3/8"-16	SSE-38-16-313	20,000G2.5	D	
	1.00	1.26	-	Lyndex	C40-37EM500-L	\$152.48	3/8"-24(1)	SSE-37-24-313	-	B	
	1.00	-	-	Sowa	C40-37EM500-GB	\$110.16	3/8"-24	SSE-38-24-313	20,000	C	
6.00	-	-	-	Kingston	C40-37EM600-K	\$60.45	3/8"-16	SSE-38-16-313	15,000G6.3	F	
	1.00	3.80	0.75	Parlec*	C40-37EM600-P	\$160.65	3/8"-24(1)	SSE-38-24-313	-	A	
	-	-	-	Spin Tru	C40-43EM175-K	\$53.85	7/16"-14	SSE-44-14-375	15,000G6.3	F	
7/16"	1.75	1.25	-	-	Kingston	C40-43EM175-K	\$53.85	7/16"-14	SSE-44-14-375	20,000G2.5	D
		1.25	-	-	Spin Tru	C40-43EM175-KB	\$69.99	7/16"-14	SSE-44-14-375	20,000G2.5	D
	2.50	-	-	-	Spin Tru	C40-43EM250-KB	\$70.50	7/16"-14	SSE-44-14-375	20,000G2.5	D
		1.25	-	-	Techniks	C40-43EM250-T	\$85.00	7/16"-20	SSE-44-20-375	-	B
		1.38	1.50	-	Lyndex	C40-43EM250-L	\$121.36	7/16"-20(1)	SSE-44-20-375	-	B
	1.38	-	-	Sowa	C40-43EM250-GB	\$87.03	7/16"-20	SSE-38-24-313	20,000	C	
2.62	1.25	3.80	0.75	Parlec*	C40-43EM262-P	\$95.40	3/8"-24(1)	SSE-38-24-313(2)	-	A	
4.00	-	-	-	Spin Tru	C40-43EM400-KB	\$73.02	7/16"-14	SSE-44-14-375	20,000G2.5	D	
	1.38	-	-	Sowa	C40-43EM400-GB	\$87.03	7/16"-20	SSE-38-24-313	20,000	C	
1/2"	1.37	-	-	-	Kingston	C40-50EM137-K	\$49.95	7/16"-14	SSE-44-14-375	15,000G6.3	F
	1.38	1.25	-	-	Spin Tru	C40-50EM138-KB	\$69.99	7/16"-14	SSE-44-14-375	20,000G2.5	D
	1.75	1.25	-	-	Kingston	C40-50EM175-K	\$53.85	7/16"-14	SSE-44-14-375	15,000G6.3	F
		1.38	3	0.88	Spin Tru	C40-50EM175-KB	\$69.99	7/16"-14	SSE-44-14-375	20,000G2.5	D
		1.75	3	0.88	Parlec*	C40-50EM175-P	\$95.40	7/16"-20(1)	SSE-44-20-375	-	A
	2.50	-	-	-	Spin Tru	C40-50EM250-KB	\$70.50	7/16"-14	SSE-44-14-375	20,000G2.5	D
1.38		1.50	-	Lyndex	C40-50EM250-L	\$107.11	7/16"-20(1)	SSE-44-20-375	-	B	
1.38	-	-	-	Sowa	C40-50EM250-GB	\$99.63	7/16"-20	SSE-44-20-375	20,000	C	

(Additional 1/2" CAT-40 Endmill Holders are located on the following page)

Call Us Or Visit Our Website For Our Complete Selection!

LATHE CHUCKS
LIVE CENTERS

WISE JAWS
WISE ACCESSORIES

STRAIGHT SHANK
COLLET HOLDERS

TAP HOLDERS
DRILL CHUCKS

CARBIDE INSERTS
THREADING/GROOVING

CUTTING TOOLS
MACHINERY

PRECISION TOOLS
DEBURRING

COOLANT/FLUIDS
TOOL STORAGE

CAT-40 V-FLANGE TOOLHOLDERS

END MILL HOLDERS



- Large selection of end mill holders from nationally recognized manufacturers
- **Kingston Toolholders** are balanced to 15,000 RPM @ g6.3
- **Spin Tru Toolholders** are balanced to 20,000 RPM @ g2.5
- Full line available from all vendors listed-please call for information

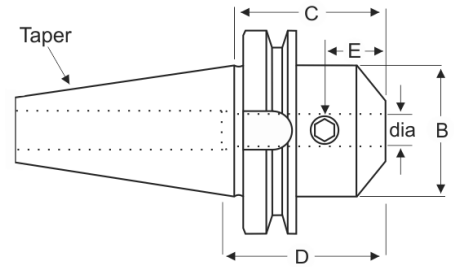

CAT 40		ENDMILL HOLDERS										
Dia	C Proj.	B OD	D Max Socket Depth	E	Brand	Part Number	Price Each	Set Screw Size	Set Screw Part Number	MAX RPM Balanced Up to	Code	
1/2" (cont.)	2.62	1.25	-	-	Kingston	C40-50EM262-K	\$53.85	7/16"-14	SSE-44-14-375	15,000G6.3	F	
		1.25	3.80	0.88	Parlec*	C40-50EM262-P	\$95.40	7/16"-20(1)	SSE-44-20-375	-	A	
	4.00	1.38	-	-	-	Techniks	C40-50EM300-T	\$78.30	7/16"-20	SSE-44-20-437	-	B
			-	-	-	Spin Tru	C40-50EM400-KB	\$69.46	7/16"-14	SSE-44-14-375	20,000G2.5	D
		1.38	-	-	Lyndex	C40-50EM400-L	\$128.73	7/16"-20(1)	SSE-44-20-375	-	B	
	4.62	1.25	3.80	0.88	Parlec*	Sowa	C40-50EM400-GB	\$99.63	7/16"-20	SSE-44-20-375	20,000	C
						Kingston	C40-50EM462-P	\$130.50	7/16"-20(1)	SSE-44-20-375	-	A
	5.00	1.38	1.50	-	-	Kingston	C40-50EM500-K	\$60.45	7/16"-14	SSE-44-14-375	15,000G6.3	F
						Spin Tru	C40-50EM500-KB	\$77.98	7/16"-14	SSE-44-14-375	20,000G2.5	D
		1.38	-	-	-	Lyndex	C40-50EM500-L	\$152.48	7/16"-20(1)	SSE-44-20-375	-	B
						Sowa	C40-50EM500-GB	\$110.16	7/16"-20	SSE-44-20-375	20,000	C
	6.00	1.25	3.12	0.88	Parlec*	Kingston	C40-50EM600-K	\$60.45	7/16"-14	SSE-44-14-375	15,000G6.3	F
Spin Tru						C40-50EM600-P	\$146.25	7/16"-20(1)	SSE-44-20-375	-	A	
-		-	-	-	Kingston	C40-56EM175-K	\$53.85	7/16"-14	SSE-44-14-375	15,000G6.3	F	
9/16"	1.75	-	-	-	Spin Tru	C40-56EM175-KB	\$69.99	7/16"-14	SSE-44-14-375	20,000G2.5	D	
					Parlec	C40-56EM175-P	\$143.10	7/16"-20(1)	SSE-44-20-375	-	A	
	1.75	2.18	0.88	Kingston	C40-62EM138-K	\$49.95	9/16"-12	SSE-46-12-500	15,000G6.3	F		
5/8"	1.38	1.50	-	-	Spin Tru	C40-62EM138-KB	\$69.99	9/16"-12	SSE-46-12-500	20,000G2.5	D	
					Kingston	C40-62EM175-K	\$53.85	9/16"-12	SSE-46-12-500	15,000G6.3	F	
	1.75	1.62	2.38	0.94	Spin Tru	C40-62EM175-KB	\$69.99	9/16"-12	SSE-46-12-500	20,000G2.5	D	
						Parlec	C40-62EM175-P	\$95.40	9/16"-18(1)	SSE-56-18-430	-	A
		1.75	-	-	-	Techniks	C40-62EM175-T	\$72.25	1/2"-20	SSE-50-20-500	-	B
						Lyndex	C40-62EM175-L	\$121.36	9/16"-18(1)	SSE-56-18-500	-	B
	2.75	-	-	-	Kingston	C40-62EM275-K	\$53.85	9/16"-12	SSE-46-12-500	15,000G6.3	F	
	3.00	1.50	-	-	-	Kingston	C40-62EM300-K	\$53.85	9/16"-12	SSE-46-12-500	15,000G6.3	F
						Spin Tru	C40-62EM300-KB	\$69.99	9/16"-12	SSE-46-12-500	20,000G2.5	D
		1.65	1.61	-	-	Lyndex	C40-62EM300-L	\$115.66	9/16"-18(1)	SSE-56-18-500	-	B
						Sowa	C40-62EM300-GB	\$99.63	9/16"-18	SSE-56-18-500	20,000	C
	3.90	-	-	-	Kingston	C40-62EM390-K	\$53.85	9/16"-12	SSE-46-12-500	15,000G6.3	F	
	4.00	1.65	-	-	-	Spin Tru	C40-62EM400-KB	\$73.02	9/16"-12	SSE-46-12-500	20,000G2.5	D
						Sowa	C40-62EM400-GB	\$99.63	9/16"-18	SSE-56-18-500	20,000	C
		5.50	-	-	-	Spin Tru	C40-62EM550-KB	\$73.02	9/16"-12	SSE-46-12-500	20,000G2.5	D
7.75	1.50	-	-	-	Kingston	C40-62EM775-K	\$60.45	9/16"-12	SSE-46-12-500	15,000G6.3	F	
					Spin Tru	C40-62EM775-KB	\$74.47	9/16"-12	SSE-46-12-500	20,000G2.5	D	
3/4"	1.37	-	-	-	Kingston	C40-75EM137-K	\$49.95	5/8"-11	SSE-62-11-500	15,000G6.3	F	
					Spin Tru	C40-75EM138-KB	\$69.99	5/8"-11	SSE-62-11-500	20,000G2.5	D	
	1.75	1.75	-	-	-	Kingston	C40-75EM175-K	\$53.85	5/8"-11	SSE-62-11-500	15,000G6.3	F
						Spin Tru	C40-75EM175-KB	\$69.99	5/8"-11	SSE-62-11-500	20,000G2.5	D
		1.75	3.94	1	-	Parlec	C40-75EM175-P	\$106.20	5/8"-18(1)	SSE-62-18-500	-	A
							Techniks	C40-75EM175-T	\$80.75	5/8"-18	SSE-62-18-500	-
	1.89	1.77	-	-	Lyndex	C40-75EM175-L	\$121.36	5/8"-18(1)	SSE-62-18-500	-	B	
						Kingston	C40-75EM300-K	\$53.85	5/8"-11	SSE-62-11-500	15,000G6.3	F
	3.00	1.75	4.06	1	-	Spin Tru	C40-75EM300-KB	\$69.99	5/8"-11	SSE-62-11-500	20,000G2.5	D
						Lyndex	C40-75EM300-L	\$107.11	5/8"-18(1)	SSE-62-18-500	-	B
		1.75	-	-	-	Sowa	C40-75EM300-GB	\$99.63	5/8"-18	SSE-62-18-500	20,000	C
	3.50	1.75	3.94	1	-	Kingston	C40-75EM350-K	\$53.85	5/8"-11	SSE-62-11-500	15,000G6.3	F
Parlec*						C40-75EM350-P	\$95.40	5/8"-18(1)	SSE-62-18-500	-	A	
3.75	1.75	-	-	-	Kingston	C40-75EM375-K	\$53.85	5/8"-11	SSE-62-11-500	15,000G6.3	F	

Call Us Today For All Of Your Machine Tool Needs!

CAT-40 V-FLANGE TOOLHOLDERS

END MILL HOLDERS



- Large selection of end mill holders from nationally recognized manufacturers
- **Kingston Toolholders** are balanced to 15,000 RPM @ g6.3
- **Spin Tru Toolholders** are balanced to 20,000 RPM @ g2.5
- Full line available from all vendors listed-please call for information

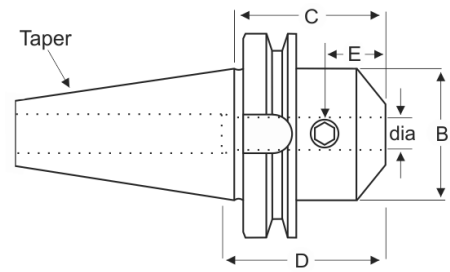

CAT 40 ENDMILL HOLDERS

Dia	C Proj.	B OD	D Max Socket Depth	E	Brand	Part Number	Price Each	Set Screw Size	Set Screw Part Number	MAX RPM Balanced Up to	Code
3/4"	4.00	—	—	—	Spin Tru	C40-75EM400-KB	\$73.02	5/8"-11	SSE-62-11-500	20,000G2.5	D
		1.75	1.77	—	Lyndex	C40-75EM400-L	\$128.73	5/8"-18(1)	SSE-62-18-500	-	B
		1.75	—	—	Sowa	C40-75EM400-GB	\$99.63	5/8"-18	SSE-62-18-500	20,000	C
	5.50	—	—	—	Spin Tru	C40-75EM550-KB	\$73.02	5/8"-11	SSE-62-11-500	20,000G2.5	D
		1.75	1.77	—	Lyndex	C40-75EM550-L	\$152.48	5/8"-18(1)	SSE-62-18-500	-	B
		1.75	—	—	Kingston	C40-75EM575-K	\$60.45	5/8"-11	SSE-62-11-500	15,000G6.3	F
7.75	1.75	—	—	Kingston	C40-75EM775-K	\$60.45	5/8"-11	SSE-62-11-500	15,000G6.3	F	
	1.75	—	—	Spin Tru	C40-75EM775-KB	\$74.47	5/8"-11	SSE-62-11-500	20,000G2.5	D	
7/8"	1.37	-	-	-	Kingston	C40-87EM137-K	\$49.95	5/8"-11	SSE-62-11-500	15,000G6.3	F
	1.38	2	-	-	Spin Tru	C40-87EM138-KB	\$69.99	5/8"-11	SSE-62-11-500	20,000G2.5	D
	1.75	2	-	-	Kingston	C40-87EM175-K	\$53.85	5/8"-11	SSE-62-11-500	15,000G6.3	F
		1.75	2.27	1	Spin Tru	C40-87EM175-KB	\$69.99	5/8"-11	SSE-62-11-500	20,000G2.5	D
	1.94	-	-	-	Sowa	C40-87EM175-GB	\$121.50	5/8"-18	SSE-62-18-500	20,000	C
		2	4.31	1	Spin Tru	C40-87EM350-KB	\$73.02	5/8"-11	SSE-62-11-500	20,000G2.5	D
	3.50	1.75	4.25	1	Parlec*	C40-87EM350-P	\$144.90	5/8"-18	SSE-62-18-500	-	A
		2.05	-	-	Techniks	C40-87EM350-T	\$87.30	5/8"-18	SSE-62-18-500	-	B
	3.75	1.88	4.25	1	Parlec*	C40-87EM375-P	\$106.20	5/8"-18(2)	SSE-62-18-500	-	B
	3.90	-	-	-	Kingston	C40-87EM390-K	\$53.85	5/8"-11	SSE-62-11-500	15,000G6.3	F
	4.00	2	-	-	Spin Tru	C40-87EM400-KB	\$73.02	5/8"-11	SSE-62-11-500	20,000G2.5	D
	6.00	2	-	-	Kingston	C40-87EM600-K	\$60.45	5/8"-11	SSE-62-11-500	15,000G6.3	F
		2	4.31	1	Spin Tru	C40-87EM600-KB	\$74.47	5/8"-11	SSE-62-11-500	20,000G2.5	D
	1.88	4.25	1	Parlec*	C40-87EM600-P	\$144.90	5/8"-18(2)	SSE-62-18-500	-	A	
		2	-	-	Kingston	C40-87EM775-K	\$60.45	5/8"-11	SSE-62-11-500	15,000G6.3	F
2	-	-	-	Spin Tru	C40-87EM775-KB	\$74.47	5/8"-11	SSE-62-11-500	20,000G2.5	D	
1"	1.37	-	-	-	Kingston	C40-10EM137-K	\$49.95	3/4"-10	SSE-75-10-563	15,000G6.3	F
	1.38	2.38	-	-	Spin Tru	C40-10EM138-KB	\$69.99	3/4"-10	SSE-75-10-563	20,000G2.5	D
	1.75	2.38	-	-	Kingston	C40-10EM175-K	\$53.85	3/4"-10	SSE-75-10-563	15,000G6.3	F
		2.38	-	-	Spin Tru	C40-10EM175-KB	\$69.99	3/4"-10	SSE-75-10-563	20,000G2.5	D
	2.00	2.38	1.12	Parlec	C40-10EM175-P	\$104.40	-	SS-029-955-P	-	A	
	2.00	-	-	-	Kingston	C40-10EM200-K	\$53.85	3/4"-10	SSE-75-10-563	15,000G6.3	F
		-	-	-	Spin Tru	C40-10EM200-KB	\$69.99	3/4"-10	SSE-75-10-563	20,000G2.5	D
	2.25	2.25	-	-	Sowa	C40-10EM200-GB	\$98.82	3/4"-16	SSE-75-16-688	20,000	C
		-	-	-	Kingston	C40-10EM225-K	\$53.85	3/4"-10	SSE-75-10-563	15,000G6.3	F
	3.00	-	-	-	Spin Tru	C40-10EM225-KB	\$69.99	3/4"-10	SSE-75-10-563	20,000G2.5	D
		2.38	-	-	Kingston	C40-10EM300-K	\$53.85	3/4"-10	SSE-75-10-563	15,000G6.3	F
	4.00	2.38	-	-	Spin Tru	C40-10EM300-KB	\$69.99	3/4"-10	SSE-75-10-563	20,000G2.5	D
		2.00	3.00	1.12	Parlec	C40-10EM300-P	\$127.35	5/8"-18(2)	SSE-62-18-500	-	A
		2.38	-	-	Kingston	C40-10EM400-K	\$53.85	3/4"-10	SSE-75-10-563	15,000G6.3	F
	6.00	1.75	2.75	1.13	Spin Tru	C40-10EM400-KB	\$69.46	3/4"-10	SSE-75-10-563	20,000G2.5	D
2.00		4.50	1.12	Parlec*	C40-10EM400-P	\$106.20	3/4"-16(2)	SSE-75-16-500	-	A	
2.36		2.36	-	Lyndex	C40-10EM400-L	\$119.23	3/4"-16(2)	SSE-75-16-688	-	B	
2.36		-	-	Sowa	C40-10EM400-GB	\$99.63	3/4"-16	SSE-75-16-688	20,000	C	
8.00	2.38	-	-	Kingston	C40-10EM600-K	\$60.45	3/4"-10	SSE-75-10-563	15,000G6.3	F	
	2.00	4.43	1.13	Spin Tru	C40-10EM600-KB	\$74.47	3/4"-10	SSE-75-10-563	20,000G2.5	D	
	2.36	2.36	-	Lyndex	C40-10EM600-L	\$137.75	3/4"-16(2)	SSE-75-16-688	-	B	
	2.36	-	-	Sowa	C40-10EM600-GB	\$138.06	3/4"-16	SSE-75-16-688	20,000	C	
2.38	-	-	-	Kingston	C40-10EM800-K	\$60.45	3/4"-10	SSE-75-10-563	15,000G6.3	F	
	2.38	-	-	Spin Tru	C40-10EM800-KB	\$74.47	3/4"-10	SSE-75-10-563	20,000G2.5	D	

LATHE CHUCKS
LIVE CENTERS

WISE JAWS
WISE ACCESSORIES

STRAIGHT SHANK
COLLET HOLDERS

TAP HOLDERS
DRILL CHUCKS

CARBIDE INSERTS
THREADING/GROOVING

CUTTING TOOLS
MACHINERY

PRECISION TOOLS
DEBURRING

COOLANT/FLUIDS
TOOL STORAGE

Call Us Or Visit Our Website For Our Complete Selection!

CAT-40 V-FLANGE TOOLHOLDERS

END MILL HOLDERS



- Large selection of end mill holders from nationally recognized manufacturers
- **Kingston Toolholders** are balanced to 15,000 RPM @ g6.3
- **Spin Tru Toolholders** are balanced to 20,000 RPM @ g2.5
- Full line available from all vendors listed-please call for information

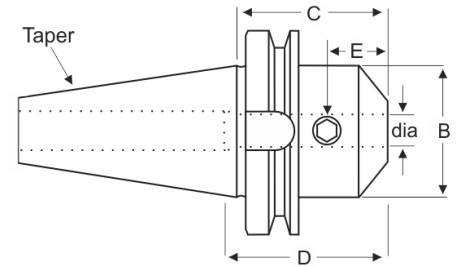

CAT 40 ENDMILL HOLDERS

Dia	C Proj.	B OD	D Max Socket Depth	E	Brand	Part Number	Price Each	Set Screw Size	Set Screw Part Number	MAX RPM Balanced Up to	Code
1-1/4"	2.00	2.50	-	-	Kingston	C40-12EM200-K	\$53.85	3/4"-10	SSE-75-10-500	15,000G6.3	F
		2.25	2.25	1.13	Spin Tru	C40-12EM200-KB	\$69.99	3/4"-10	SSE-75-10-500	20,000G2.5	D
		2.25	2.28	-	Lyndex	C40-12EM200-L	\$144.88	3/4"-16(1)	SSE-75-16-688	-	B
		2.25	-	-	Sowa	C40-12EM200-GB	\$108.00	3/4"-16	SSE-75-16-688	20,000	C
	4.00	-	-	-	Spin Tru	C40-12EM400-KB	\$73.02	3/4"-10	SSE-75-10-500	20,000G2.5	D
		2.25	3.75	1.12	Parlec	C40-12EM400-P	\$117.90	3/4"-16(2)	SSE-75-16-625	-	A
		2.48	2.55	-	Lyndex	C40-12EM400-L	\$136.33	3/4"-16(2)	SSE-75-16-688	-	B
		2.48	-	-	Sowa	C40-12EM400-GB	\$99.63	3/4"-16	SSE-75-16-688	20,000	C
	4.25	2.50	-	-	Kingston	C40-12EM425-K	\$53.85	3/4"-10	SSE-75-10-500	15,000G6.3	F
	4.60	2.75	-	-	Techniks	C40-12EM460-T	\$97.20	3/4"-16	SSE-75-16-625	-	B
	6.00	-	-	-	Kingston	C40-12EM600-K	\$60.45	3/4"-10	SSE-75-10-500	15,000G6.3	F
		-	-	-	Spin Tru	C40-12EM600-KB	\$74.47	3/4"-10	SSE-75-10-500	20,000G2.5	D
2.50		3.75	1.12	Parlec	C40-12EM600-P	\$160.65	3/4"-16(2)	SSE-75-16-625	-	A	
8.00	2.50	-	-	Kingston	C40-12EM800-K	\$60.45	3/4"-10	SSE-75-10-500	15,000G6.3	F	
	2.50	-	-	Spin Tru	C40-12EM800-KB	\$74.47	3/4"-10	SSE-75-10-500	20,000G2.5	D	
1-1/2"	4.00	-	-	-	Kingston	C40-15EM400-K	\$53.85	3/4"-10	SSE-75-10-500	15,000G6.3	F
	-	2.62	2.38	1.12	Parlec	C40-15EM400-P	\$133.20	3/4"-16(2)	SSE-75-16-625	-	B
	4.35	-	-	-	Kingston	C40-15EM435-K	\$53.85	3/4"-10	SSE-75-10-688	15,000G6.3	F
	2.99	2.55	-	-	Lyndex	C40-15EM450-L	\$146.30	3/4"-16(2)	SSE-75-16-688	-	B
	2.99	-	-	-	Sowa	C40-15EM450-GB	\$119.88	3/4"-16	SSE-75-16-688	20,000	C
	4.62	2.62	2.38	1.12	Parlec	C40-15EM462-P	\$135.45	3/4"-16(2)	SSE-75-16-625	-	A
	6.00	-	-	-	Spin Tru	C40-15EM600-KB	\$75.54	3/4"-10	SSE-75-10-688	20,000G2.5	D
	6.62	2.75	-	-	Kingston	C40-15EM662-K	\$60.45	3/4"-10	SSE-75-10-688	15,000G6.3	F
8.63	2.75	-	-	Kingston	C40-15EM863-K	\$60.45	3/4"-10	SSE-75-10-688	15,000G6.3	F	
	2.75	-	-	Spin Tru	C40-15EM863-KB	\$74.47	3/4"-10	SSE-75-10-688	20,000G2.5	D	

CAT 40 METRIC END MILL HOLDERS



- Large selection of end mill holders from nationally recognized manufacturers
- Full line available from all vendors listed-please call for information

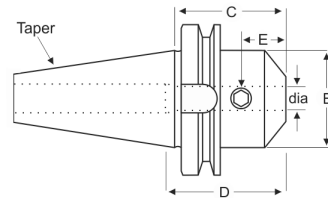

A Dia.	C Proj.	B OD	D Max Socket Depth	Brand	Part Number	Price Each	Set Screw Size	Set Screw Part Number	Code
6MM	2.50	0.78	1.10	Lyndex	C40-M06EM250-L	\$132.53	1/4"-28	SSE-25-28-250	B
8MM	2.50	0.87	1.25	Lyndex	C40-M08EM250-L	\$132.53	5/16"-24	SSE-31-24-250	B
10MM	2.50	1.00	1.25	Lyndex	C40-M10EM250-L	\$132.53	3/8"-24	SSE-37-24-313	B
12MM	2.50	1.38	1.50	Lyndex	C40-M12EM250-L	\$132.53	7/16"-20	SSE-44-20-375	B
	2.62	1.25	3.50	Parlec	C40-M12EM262-P	\$132.30	7/16"-20	SSE-44-20-375	A
14MM	3.00	1.65	1.61	Lyndex	C40-M14EM300-L	\$144.40	9/16"-18	SSE-56-18-500	B
16MM	2.75	1.50	2.13	Parlec	C40-M16EM275-P	\$132.30	9/16"-18	SSE-56-18-430	A
	3.00	1.65	1.61	Lyndex	C40-M16EM300-L	\$132.53	9/16"-18	SSE-56-18-500	B
18MM	3.00	1.75	1.77	Lyndex	C40-M18EM300-L	\$132.53	5/8"-18x1/2	SSE-62-18-500	B
20MM	3.00	1.75	1.77	Lyndex	C40-M20EM300-L	\$132.53	5/8"-18x1/2	SSE-62-18-500	B
	3.50	1.75	2.25	Parlec	C40-M20EM350-P	\$132.30	5/8"-18	SSE-62-18-500	A
25MM	4.00	2.00	3.00	Parlec	C40-M25EM400-P	\$158.85	3/4"-16(2)	SSE-75-16-500	A
	4.00	2.36	2.36	Lyndex	C40-M25EM400-L	\$137.99	3/4"-16(2)	SSE-75-16-688	B
32MM	4.00	2.48	2.36	Lyndex	C40-M32EM400-L	\$153.90	3/4"-16(2)	SSE-75-16-688	B

Call Us Today For All Of Your Machine Tool Needs!

CAT-40 V-FLANGE ER COLLET CHUCKS

ER COLLET CHUCKS

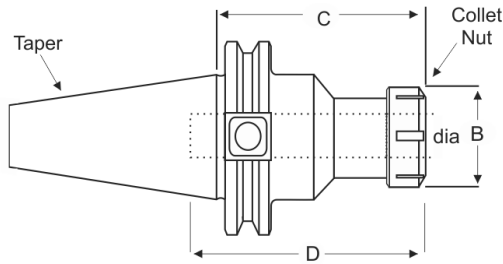

C Proj.	B Nut Dia.	D Socket Depth	Nut Tight. Torque (ft.lbs.)	Brand	Part Number	Price Each	MAX RPM Balanced Up to	Collet Nut	Wrench	Code
---------	------------	----------------	-----------------------------	-------	-------------	------------	------------------------	------------	--------	------

ER 8 ER-8 Collet Series- 0.019-0.196 (0.5mm-5mm)										
2.50	0.47	-	-	Lyndex	C40-08ER250-L	\$202.59	-	CN-ER08-L	WR-ER08-L	B

ER 11 ER-11 Collet Series- 0.020-0.275 (0.5mm-7mm)										
2.50	0.75	-	22	KINGSTON	C40-11ER250-K	\$79.95	15,000G6.3	CN-ER11-K	WR-ER11-K	F
	0.75	2.25	22	SPIN TRU	C40-11ER250-KB	\$93.08	20,000G2.5	CN-ER11-K	WR-ER11-K	D
	0.75	2.25	22	Parlec	C40-11ER250-P	\$160.38	-	CN-ER11-P	WR-ER11-P	A
	0.75	-	22	Lyndex	C40-11ER250-L	\$198.64	-	CN-ER11-L	WR-ER11-L	B
2.75	0.63	-	14	Techniks	C40-11ER275M-T	\$152.10	18,000G2.5	CN-ER11MN-T	WR-ER11MN-T	B
4.00	0.75	2.25	22	SPIN TRU	C40-11ER400-KB	\$90.39	20,000G2.5	CN-ER11-K	WR-ER11-K	D
	0.75	-	22	Lyndex	C40-11ER400-L	\$213.99	-	CN-ER11-L	WR-ER11-L	B
6.00	0.75	-	22	KINGSTON	C40-11ER600-K	\$87.95	15,000G6.3	CN-ER11-K	WR-ER11-K	F
	0.75	2.25	22	SPIN TRU	C40-11ER600-KB	\$98.07	20,000G2.5	CN-ER11-K	WR-ER11-K	D
	0.75	-	22	Sowa	C40-11ER600-GB	\$170.91	20000	CN-ER11-G	WR-ER11-G	C

ER 16 ER-16 Collet Series-.020 - 0.393 (0.5mm - 10mm)										
2.25	1.26	-	52	Lyndex	C40-16ER225-L	\$201.40	-	CN-ER16-L	WR-ER16-L	B
2.50	1.10	-	52	KINGSTON	C40-16ER250-K	\$79.95	15,000G6.3	CN-ER16-K	WR-ER16-K	F
	1.10	-	52	SPIN TRU	C40-16ER250-KB	\$93.08	20,000G2.5	CN-ER16-K	WR-ER16-K	D
2.62	1.11	2.55	52	Parlec	C40-16ER262-P	\$189.90	-	CN-ER16PN-P	WR-ER16-P	A
3.12	1.10	-	52	KINGSTON	C40-16ER312-K	\$82.45	15,000G6.3	CN-ER16-K	WR-ER16-K	F
	1.10	-	52	SPIN TRU	C40-16ER312-KB	\$93.08	20,000G2.5	CN-ER16-K	WR-ER16-K	D
	1.11	2.12	52	Parlec	C40-16ER312-P	\$191.70	-	CN-ER16PN-P	WR-ER16-P	A
3.50	1.10	2.76	52	SPIN TRU	C40-16ER350-KB	\$90.39	20,000G2.5	CN-ER16-K	WR-ER16-K	D
	1.26	-	52	Lyndex	C40-16ER350-L	\$190.95	-	CN-ER16-L	WR-ER16-L	B
4.00	1.10	2.76	52	SPIN TRU	C40-16ER400-KB	\$92.49	20,000G2.5	CN-ER16-K	WR-ER16-K	D
	1.26	-	50	Techniks	C40-16ER400-T	\$136.80	18,000G2.5	CN-ER16-T	WR-ER16-T	B
	1.26	-	52	Sowa	C40-16ER400-GB	\$153.90	20000	CN-ER16-G	WR-ER16-G	C
5.00	1.10	-	52	KINGSTON	C40-16ER500-K	\$87.95	15,000G6.3	CN-ER16-K	WR-ER16-K	F
	1.10	-	52	SPIN TRU	C40-16ER500-KB	\$98.07	20,000G2.5	CN-ER16-K	WR-ER16-K	D
5.12	1.11	2.12	52	Parlec	C40-16ER512-P	\$208.35	-	CN-ER16PN-P	WR-ER16-P	A
6.00	1.10	2.76	52	SPIN TRU	C40-16ER600-KB	\$98.07	20,000G2.5	CN-ER16-K	WR-ER16-K	D
	1.26	-	52	Lyndex	C40-16ER600-L	\$213.99	-	CN-ER16-L	WR-ER16-L	B
8.00	1.26	-	50	Techniks	C40-16ER800-T	\$170.10	18,000G2.5	CN-ER16-T	WR-ER16-T	B

ER 20 ER-20 Collet Series-.020 - 0.500 (0.5mm - 12.7mm)										
2.50	1.34	-	74	KINGSTON	C40-20ER250-K	\$82.45	15,000G6.3	CN-ER20-K	WR-ER20-K	F
	1.34	-	74	SPIN TRU	C40-20ER250-KB	\$93.08	20,000G2.5	CN-ER20-K	WR-ER20-K	D
	1.38	-	74	Lyndex	C40-20ER250-L	\$190.95	-	CN-ER20-L	WR-ER20-L	B
3.12	1.34	-	74	KINGSTON	C40-20ER312-K	\$82.45	15,000G6.3	CN-ER20-K	WR-ER20-K	F
	1.34	-	74	SPIN TRU	C40-20ER312-KB	\$93.08	20,000G2.5	CN-ER20-K	WR-ER20-K	D
4.00	1.34	-	74	KINGSTON	C40-20ER400-K	\$82.45	15,000G6.3	CN-ER20-K	WR-ER20-K	F
	1.34	3.15	74	SPIN TRU	C40-20ER400-KB	\$92.49	20,000G2.5	CN-ER20-K	WR-ER20-K	D
	1.38	-	74	Techniks	C40-20ER400-T	\$136.80	18,000G2.5	CN-ER20-T	WR-ER20-T	B
	1.38	-	74	Sowa	C40-20ER400-GB	\$154.71	20000	CN-ER20-G	WR-ER20-G	C

(Additional ER 20 CAT-40 Collet Chucks are located on the following page)

Call Us Or Visit Our Website For Our Complete Selection!

LATHE CHUCKS
LIVE CENTERS

VICE JAWS
VICE ACCESSORIES

STRAIGHT SHANK
COLLET HOLDERS

TAP HOLDERS
DRILL CHUCKS

CARBIDE INSERTS
THREADING/GROOVING

CUTTING TOOLS
MACHINERY

PRECISION TOOLS
DEBURRING

COOLANT/FLUIDS
TOOL STORAGE

CAT-40 V-FLANGE ER COLLET CHUCKS

ER COLLET CHUCKS

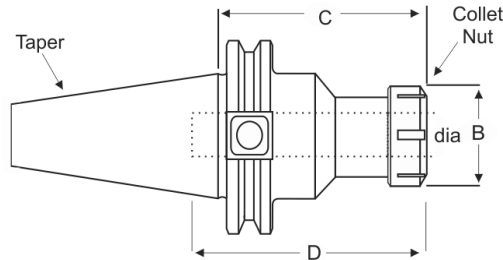

C Proj.	B Nut Dia.	D Socket Depth	Nut Tight. Torque (ft.lbs.)	Brand	Part Number	Price Each	MAX RPM Balanced Up to	Collet Nut	Wrench	Code
ER 20 ER-20 Collet Series-.020 - 0.500 (0.5mm - 12.7mm)-continued from previous page										
4.12	1.34	4.00	74	Parlec	C40-20ER412-P	\$195.75	-	CN-ER20-P	WR-ER20-P	A
6.00	1.34	-	74	KINGSTON	C40-20ER600-K	\$87.95	12,000G6.3	CN-ER20-K	WR-ER20-K	F
	1.34	-	74	SPIN TRU	C40-20ER600-KB	\$98.07	20,000G2.5	CN-ER20-K	WR-ER20-K	D
8.12	1.34	4.00	74	Parlec	C40-20ER812-P	\$246.60	-	CN-ER20-P	WR-ER20-P	A
ER 25 ER-25 Collet Series-.039 - 0.630 (1mm - 16mm)										
2.50	1.65	-	95	KINGSTON	C40-25ER250-K	\$82.45	15,000G6.3	CN-ER25-K	WR-ER25-K	F
	1.65	-	95	SPIN TRU	C40-25ER250-KB	\$95.48	20,000G2.5	CN-ER25-K	WR-ER25-K	D
	1.65	-	95	Techniks	C40-25ER250-T	\$143.00	18,000G2.5	CN-ER25-T	WR-ER25-T	B
	1.65	-	95	Sowa	C40-25ER250-GB	\$152.28	20000	CN-ER25-G	WR-ER25-G	C
2.62	1.67	2.50	95	Parlec	C40-25ER262-P	\$196.65	-	CN-ER25-P	WR-ER25-P	A
4.00	1.65	-	95	KINGSTON	C40-25ER400-K	\$82.45	15,000G6.3	CN-ER25-K	WR-ER25-K	F
	1.65	-	95	SPIN TRU	C40-25ER400-KB	\$92.49	20,000G2.5	CN-ER25-K	WR-ER25-K	D
	1.65	-	95	Techniks	C40-25ER400-T	\$147.60	18,000G2.5	CN-ER25-T	WR-ER25-T	B
	1.65	-	95	Lyndex	C40-25ER400-L	\$213.99	-	CN-ER25-L	WR-ER25-L	B
	1.65	-	95	Sowa	C40-25ER400-GB	\$165.24	20000	CN-ER25-G	WR-ER25-G	C
6.00	1.65	-	95	KINGSTON	C40-25ER600-K	\$87.95	15,000G6.3	CN-ER25-K	WR-ER25-K	F
	1.65	-	95	SPIN TRU	C40-25ER600-KB	\$98.07	20,000G2.5	CN-ER25-K	WR-ER25-K	D
8.00	1.65	-	95	Techniks	C40-25ER800-T	\$170.10	18,000G2.5	CN-ER25-T	WR-ER25-T	B
ER 32 ER-32 Collet Series-.040 - 0.810 (1mm - 20.6mm)										
1.06	1.97	-	125	SPIN TRU	C40-32ER106-KB	\$88.12	20,000G2.5	CN-ER32-K	WR-ER32-K	D
1.69	1.97	-	125	SPIN TRU	C40-32ER169-KB	\$88.12	20,000G2.5	CN-ER32-K	WR-ER32-K	D
2.50	1.97	-	125	KINGSTON	C40-32ER250-K	\$82.45	15,000G6.3	CN-ER32-K	WR-ER32-K	F
	1.97	3.46	125	SPIN TRU	C40-32ER250-KB	\$93.08	20,000G2.5	CN-ER32-K	WR-ER32-K	D
2.76	1.97	-	125	Techniks	C40-32ER276-T	\$145.80	18,000G2.5	CN-ER32-T	WR-ER32-T	B
3.00	1.97	-	125	KINGSTON	C40-32ER300-K	\$82.45	15,000G6.3	CN-ER32-K	WR-ER32-K	F
3.12	1.97	4.00	125	Parlec	C40-32ER312-P	\$215.10	-	CN-ER32-P	WR-ER32-P	A
3.13	1.97	3.46	125	SPIN TRU	C40-32ER313-KB	\$88.12	20,000G2.5	CN-ER32-K	WR-ER32-K	D
	1.97	-	125	Lyndex	C40-32ER313-L	\$190.95	-	CN-ER32-L	WR-ER32-L	B
	1.97	-	125	Sowa	C40-32ER313-GB	\$170.91	20000	CN-ER32-G	WR-ER32-G	C
4.00	1.97	-	125	KINGSTON	C40-32ER400-K	\$82.45	15,000G6.3	CN-ER32-K	WR-ER32-K	F
	1.97	3.94	125	SPIN TRU	C40-32ER400-KB	\$92.49	20,000G2.5	CN-ER32-K	WR-ER32-K	D
5.00	1.97	3.94	125	SPIN TRU	C40-32ER500-KB	\$92.66	20,000G2.5	CN-ER32-K	WR-ER32-K	D
	1.97	-	125	Lyndex	C40-32ER500-L	\$213.99	-	CN-ER32-L	WR-ER32-L	B
6.00	1.97	-	125	KINGSTON	C40-32ER600-K	\$87.95	15,000G6.3	CN-ER32-K	WR-ER32-K	F
	1.97	-	125	SPIN TRU	C40-32ER600-KB	\$98.07	20,000G2.5	CN-ER32-K	WR-ER32-K	D
8.00	1.97	-	125	Techniks	C40-32ER600-T	\$164.70	18,000G2.5	CN-ER32-T	WR-ER32-T	B
	1.97	-	125	Techniks	C40-32ER800-T	\$185.40	18,000G2.5	CN-ER32-T	WR-ER32-T	B

CNC TOOL TOTE RACKS

- Built-in end handles for comfortable carrying
- Bench mount, hand carry, or mount on top
- Made of heavy gauge steel
- Nylon inserts help protect tooling
- Painted texture black powder coating



Tool Size	Cap.	Part Number	Price
40 Taper Tools	6	HU-14780	\$68.00
50 Taper Tools	5	HU-14790	\$68.00

Call Us Today For All Of Your Machine Tool Needs!

CAT-40 V-FLANGE ER COLLET CHUCKS

ER COLLET CHUCKS

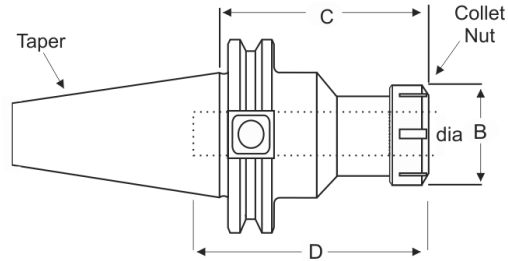

C Proj.	B Nut Dia.	D Socket Depth	Nut Tight. Torque (ft.lbs.)	Brand	Part Number	Price Each	MAX RPM Balanced Up to	Collet Nut	Wrench	Code	
ER 40 ER-40 Collet Series-.040 - 0.810 (1mm - 20.6mm)											
2.50	2.48	-	140	Kingston	C40-40ER250-K	\$82.45	15,000G6.3	CN-ER40-K	WR-ER40-K	F	
	2.48	3.1	140	Spin Tru	C40-40ER250-KB	\$93.08	20,000G2.5	CN-ER40-K	WR-ER40-K	D	
	2.48	-	140	Sowa	C40-40ER250-GB	\$170.91	20000	CN-ER40-G	WR-ER40-G	C	
3.00	2.48	-	140	Kingston	C40-40ER300-K	\$82.45	15,000G6.3	CN-ER40-K	WR-ER40-K	F	
	2.48	3.10	140	Spin Tru	C40-40ER313-KB	\$88.12	20,000G2.5	CN-ER40-K	WR-ER40-K	D	
	2.48	-	140	Lyndex	C40-40ER313-L	\$197.84	-	CN-ER40-L	WR-ER40-L	B	
3.13	2.48	-	140	Sowa	C40-40ER313-GB	\$170.91	20000	CN-ER40-G	WR-ER40-G	C	
	2.48	-	140	Techniks	C40-40ER315-T	\$152.10	18,000G2.5	CN-ER40-T	WR-ER40-T	B	
	2.48	-	140	Kingston	C40-40ER400-K	\$82.45	15,000G6.3	CN-ER40-K	WR-ER40-K	F	
4.00	2.48	5.91	140	Spin Tru	C40-40ER400-KB	\$92.49	20,000G2.5	CN-ER40-K	WR-ER40-K	D	
	4.12	2.36	4.00	162	Parlec	C40-40ER412-P	\$221.85	-	CN-ER40-P	WR-ER40-P	A
	5.00	2.48	5.91	140	Spin Tru	C40-40ER500-KB	\$92.66	20,000G2.5	CN-ER40-K	WR-ER40-K	D
6.00	2.48	-	140	Lyndex	C40-40ER500-L	\$221.83	-	CN-ER40-L	WR-ER40-L	B	
	2.48	-	140	Kingston	C40-40ER600-K	\$87.95	15,000G6.3	CN-ER40-K	WR-ER40-K	F	
	2.48	-	140	Spin Tru	C40-40ER600-KB	\$98.07	20,000G2.5	CN-ER40-K	WR-ER40-K	D	
	2.48	-	140	Techniks	C40-40ER600-T	\$180.00	18,000G2.5	CN-ER40-T	WR-ER40-T	B	

ER COLLET SETS INCH & METRIC SIZES



- Concentricity is 13 microns or 0.0005" TIR or better
- Manufactured with Swiss technology
- Crafted from high quality European alloy spring steel
- **TRUE INCH** and metric sizes
- **Fractional Collets** manufactured specifically for US market requirements
- 16 slot construction for rigid clamping and extra concentricity
- Accu-Collets improve tool life, part finish and reduces spindle wear
- Can be used for drilling, milling, tapping and reaming



Type	Style	Description	No. Of Collets	Part Number	Set Price
ER-8	Metric	1mm to 5mm x .5mm	9	08-SET9	\$118.00
	Inch	1/16"-3/16" x 1/64	9	08-SET9-INCH	\$118.00
ER-11	Metric	1mm to 7mm x .5mm	13	11-SET13	\$105.00
	Inch	1/16"-1/4" x 1/32	7	11-SET7-INCH	\$52.50
ER-16	Inch	1/16" - 1/4" x 1/64	13	11-SET13-INCH	\$105.00
	Metric	1mm to 10mm x 1mm	10	16-SET10	\$78.75
ER-20	Inch	1/16" - 3/8" x 1/32"	11	16-SET11-INCH	\$87.50
	Metric	1mm to 13mm x 1mm	12	20-SET12	\$107.25
ER-25	Inch	1/16" - 1/2" x 1/32"	15	20-SET15-INCH	\$136.50
	Metric	2mm to 16mm x 1mm	15	25-SET15	\$136.50
ER-32	Inch	3/32" - 5/8" x 1/32"	18	25-SET18-INCH	\$165.75
	Metric	3mm to 20mm x 1mm	18	32-SET18	\$174.25
ER-40	Inch	1/8"-3/4" x 1/32"	21	32-SET21-INCH	\$205.00
	Metric	4mm to 26mm x 1mm	23	40-SET23	\$247.50
	Inch	1/8"-1" x 1/16"	15	40-SET15-INCH	\$157.50
	Inch	1/8" - 1" x 1/32"	29	40-SET29-INCH	\$315.00

TOOL FIXTURES



- FEATURES:**
- Holds your CAT-40/50 Tool Holders and keeps them from moving while being tightened.
 - Universal Handle makes it easy to use in any position.

Taper	Part Number	Price Each
CAT 40	TF-4001-K	\$74.99
CAT 50	TF-5001-K	\$93.50



PLASTIC HOLDING TRAYS For CAT or BT Taper Toolholders

BEST VALUE

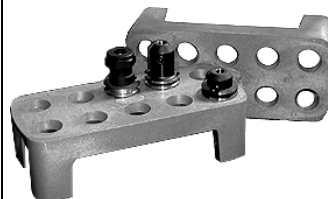

- Sturdy trays are available for CAT/BT 30, CAT/BT 40 and 50 taper toolholders
- An inexpensive way to organize your tool holders.

Taper Size	No. of Holes	Part Number	Price Each
CAT/BT30	10	TRAY30-10	\$29.95
CAT/BT40	10	TRAY40-10	\$29.95
CAT/BT 50	6	TRAY50-6	\$34.95

Call Us Or Visit Our Website For Our Complete Selection!

LATHE CHUCKS
LIVE CENTERS

WISE JAWS
WISE ACCESSORIES

STRAIGHT SHANK
COLLET HOLDERS

TAP HOLDERS
DRILL CHUCKS

CARBIDE INSERTS
THREADING/GROOVING

CUTTING TOOLS
MACHINERY

PRECISION TOOLS
DEBURRING

COOLANT/FLUIDS
TOOL STORAGE

CAT-40 V-FLANGE DA COLLET CHUCKS

DA SERIES COLLET CHUCKS

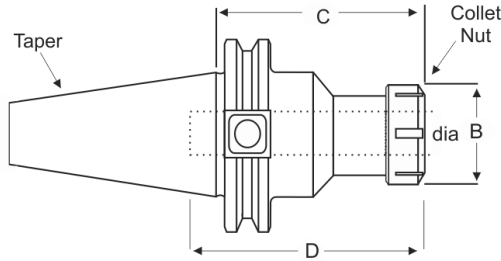

C Proj.	B Nut Dia.	D Socket Depth	Nut Tight. Torque (ft.lbs.)	Brand	Part Number	Price Each	MAX RPM Balanced Up to	Collet Nut	Wrench	Code
DA 100 DA100 Collet Series-.062 - 0.562 (1.587mm - 14.287mm)										
3.50	-	-	-	Kingston	C40-10DA350-K	\$87.84	15,000G6.3	CN-DA100-K	WR-DA100-K	F
	1.06	-	-	Lyndex	C40-10DA350-L	\$167.20	-	CN-DA100-L	WR-DA100-L	B
6.00	1.06	-	-	Lyndex	C40-10DA600-L	\$188.10	-	CN-DA100-L	WR-DA100-L	B

DA 180 DA180 Collet Series-.031 - 0.750 (.800mm - 19mm)										
2.95	1.44	3.00	40	Parlec	C40-18DA295-P	\$160.65	-	CN-DA180-L-P	WR-DA180-L-P	A
3.00	-	-	-	Kingston	C40-18DA300-K	\$87.84	15,000G6.3	CN-DA180-K	WR-DA180-K	F
4.00	1.44	-	-	Lyndex	C40-18DA400-L	\$167.20	-	CN-DA180-L	WR-DA180-L	B
5.15	-	-	-	Kingston	C40-18DA515-K	\$98.84	15,000G6.3	CN-DA180-K	WR-DA180-K	F
	1.44	4.88	40	Parlec	C40-18DA515-P	\$190.80	-	CN-DA180-L-P	WR-DA180-L-P	A
6.00	1.44	-	-	Lyndex	C40-18DA600-L	\$188.10	-	CN-DA180-L	WR-DA180-L	B

DA 200 DA200 Collet Series-.031 - 0.375 (.800mm - 9.5mm)										
2.73	1.10	2.50	30	Parlec	C40-20DA273-P	\$160.65	-	CN-DA200-P	WR-DA200-P	A
2.75	-	-	-	Kingston	C40-20DA275-K	\$87.84	15,000G6.3	CN-DA200-K	WR-DA200-K	F
3.00	-	-	-	Kingston	C40-20DA300-K	\$87.84	15,000G6.3	CN-DA200-K	WR-DA200-K	F
	0.81	3.00	30	Parlec	C40-20DA300-P	\$169.65	-	CN-DA200-L-P	WR-DA200-L-P	A
	0.86	-	-	Lyndex	C40-20DA300-L	\$169.10	-	CN-DA200-L	WR-DA200-L	B
5.00	-	-	-	Kingston	C40-20DA500-K	\$98.84	15,000G6.3	CN-DA200-K	WR-DA200-K	F
	0.81	5.00	30	Parlec	C40-20DA500-P	\$212.40	-	CN-DA200-L-P	WR-DA200-L-P	A

DA 300 DA300 Collet Series-.031 - 0.250 (.800mm - 6.4mm)										
3.00	0.55	-	-	Lyndex	C40-30DA300-L	\$169.10	-	CN-DA300-L	WR-DA300-L	B
3.38	-	-	-	Kingston	C40-30DA338-K	\$87.84	15,000G6.3	CN-DA300-K	WR-DA300-K	F
	0.62	3.00	25	Parlec	C40-30DA338-P	\$169.65	-	CN-DA300-P	WR-DA300-P	A
5.15	0.62	3.00	25	Parlec	C40-30DA515-P	\$212.40	-	CN-DA300-P	WR-DA300-P	A

DA COLLET SETS



FEATURES:

- DA Collets collapse approx. 1/32"
- Machined to exacting standards
- Ideal choice for high speed and high precision drilling operations
- Tolerance: 0.0003" at collet nose
- Customized sets available! Please call for more information

Collet Series	Description	Part Number	Price
DA300	9 Pieces (1/8"-1/4") by 64ths	DA300-SET9	\$99.00
DA200	17 Pieces (1/8"-3/8") by 64ths	DA200-SET17	\$187.00
DA100	29 Pieces (1/8"-9/16") by 64ths	DA100-SET29	\$319.00
DA180	33 Pieces(1/4-3/4) by 64ths	DA180-SET33	\$445.50
DA180	21 Pieces(1/8-3/4) by 32nds	DA180-SET21	\$283.50

Call Us Today For All Of Your Machine Tool Needs!

CAT-40 V-FLANGE TG & AF COLLET CHUCKS

TG SERIES COLLET CHUCKS

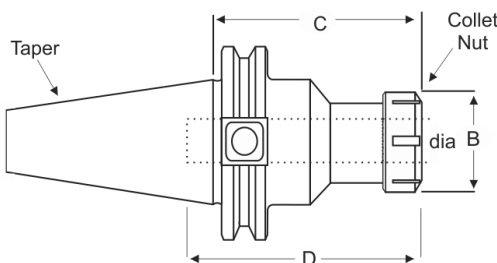

C Proj.	B Nut Dia.	D Socket Depth	Nut Tight. Torque (ft.lbs.)	Brand	Part Number	Price Each	MAX RPM Balanced Up to	Collet Nut	Wrench	Code
TG 075 TG-75 Collet Series-3/64 to 3/4 (1.2mm - 19.1mm)										
2.50	1.89	-	60	Lyndex	C40-75TG250-L	\$152.95	-	CN-TG075-L	WR-TG075-L	B
2.75	1.97	-	60	Spin Tru	C40-75TG275-KB	\$83.01	20,000G2.5	CN-TG075-K	WR-TG075-K	D
	1.88	-	100	Techniks	C40-75TG275-T	\$194.40	18,000G2.5	CN-TG075-T	WR-TG075-T	B
3.00	1.97	-	60	Kingston	C40-75TG300-K	\$65.95	15,000G6.3	CN-TG075-K	WR-TG075-K	F
	2.1	3	60	Parlec	C40-75TG300-P	\$139.05	-	CN-TG075-P	WR-TG075-P	A
6.00	1.97	-	60	Kingston	C40-75TG600-K	\$84.65	15,000G6.3	CN-TG075-K	WR-TG075-K	F
	1.97	-	60	Spin Tru	C40-75TG600-KB	\$113.41	20,000G2.5	CN-TG075-K	WR-TG075-K	D
TG 100 TG-100 Collet Series-5/64 to 1" (2mm - 25.4mm)										
2.75	2.50	-	60	Lyndex	C40-10TG275-L	\$152.95	-	CN-TG100-L	WR-TG100-L	B
3.00	2.44	-	60	Kingston	C40-10TG300-K	\$65.95	15,000G6.3	CN-TG100-K	WR-TG100-K	F
	2.44	-	60	Spin Tru	C40-10TG300-KB	\$82.15	20,000G2.5	CN-TG100-K	WR-TG100-K	D
	2.44	3.35	60	Parlec	C40-10TG300-P	\$117.90	-	CN-TG100-P	WR-TG100-P	A
	2.36	-	100	Techniks	C40-10TG300-T	\$99.90	18,000G2.5	CN-TG100-T	WR-TG100-T	B
4.00	2.44	-	60	Kingston	C40-10TG400-K	\$84.65	15,000G6.3	CN-TG100-K	WR-TG100-K	F
	2.44	-	60	Spin Tru	C40-10TG400-KB	\$105.44	20,000G2.5	CN-TG100-K	WR-TG100-K	D
	2.36	-	100	Techniks	C40-10TG400-T	\$104.40	18,000G2.5	CN-TG100-T	WR-TG100-T	B
5.00	2.44	-	60	Kingston	C40-10TG500-K	\$84.65	15,000G6.3	CN-TG100-K	WR-TG100-K	F
	2.44	4.54	60	Parlec	C40-10TG500-P	\$120.60	-	CN-TG100-P	WR-TG100-P	A
5.50	2.44	-	60	Kingston	C40-10TG550-K	\$84.65	15,000G6.3	CN-TG100-K	WR-TG100-K	F
	2.44	-	60	Sowa	C40-10TG550-GB	\$128.79	20000	CN-TG100-G	WR-TG100-G	C
6.00	2.44	-	60	Kingston	C40-10TG600-K	\$84.65	15,000G6.3	CN-TG100-K	WR-TG100-K	F
	2.44	-	60	Spin Tru	C40-10TG600-KB	\$113.41	20,000G2.5	CN-TG100-K	WR-TG100-K	D
6.50	2.44	-	60	Kingston	C40-10TG650-K	\$84.65	15,000G6.3	CN-TG100-K	WR-TG100-K	F
	2.44	6.00	60	Parlec	C40-10TG650-P	\$133.20	-	CN-TG100-P	WR-TG100-P	A
TG 150 TG-150 Collet Series-23/64 to 1-1/2" (9.1mm - 38.1mm)										
4.88	3.50	-	70	Kingston	C40-15TG488-K	\$84.65	15,000G6.3	CN-TG150-K	WR-TG100-K	F
	3.50	-	70	Spin Tru	C40-15TG488-KB	\$105.44	20,000G2.5	CN-TG150-K	WR-TG100-K	D
6.00	3.50	-	70	Lyndex	C40-15TG600-L	\$335.59	-	CN-TG150-L	WR-TG150-L	B

TG COLLET SETS

FEATURES:

- TG Collets collapse approx. 1/64"
- Machined to exacting standards
- Ideal choice for high speed and high precision milling and drilling operations
- Tolerance: 0.0003" at collet nose
- Sets available in TG 75, 100 & 150
- Different set quantities available

Accu-Collets



Collet Series	Set Qty	Range	Part Number	Price
TG 75	11	1/8"-3/4"-16ths	075-SET11	\$203.50
	22	1/8"-3/4"-32nds	075-SET22	\$407.00
	43	3/32"-3/4"-64ths	075-SET43	\$795.50
TG 100	59	3/32"-1"-64ths	100-SET59	\$1,121.00
	41	3/8"-1"-64ths	100-SET41	\$779.00
	30	3/32"-1"-32nds	100-SET30	\$570.00
	21	3/8"-1"-32nds	100-SET21	\$399.00
	15	1/8"-1"-16ths	100-SET15	\$285.00
TG 150	33	1/2"-1-1/2" - 32nds	150-SET33	\$1,402.00

Call Us Or Visit Our Website For Our Complete Selection!

LATHE CHUCKS
LIVE CENTERS
VISE JAWS
VISE ACCESSORIES
STRAIGHT SHANK
COLLET HOLDERS
TAP HOLDERS
DRILL CHUCKS
CARBIDE INSERTS
THREADING/GROOVING
CUTTING TOOLS
MACHINERY
PRECISION TOOLS
DEBURRING
COOLANT/FLUIDS
TOOL STORAGE

CAT-40 JACOBS/MORSE TAPER HOLDERS

JACOBS TAPER HOLDERS

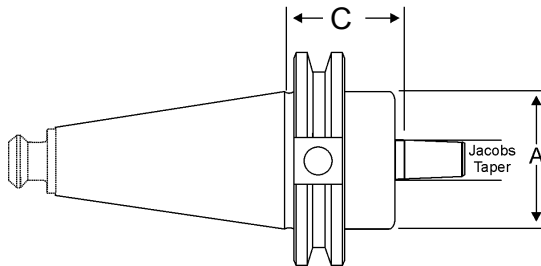

Jacobs Taper	C Proj	A Dia	Brand	Part Number	Price	Code
JT1	2.16	0.39	Kingston	C40-01JT216-K	\$65.95	F
	2.16	0.39	Spin Tru	C40-01JT216-KB	\$65.95	D
JT2	1.50	-	Kingston	C40-02JT150-K	\$65.95	F
	1.50	-	Spin Tru	C40-02JT150-KB	\$65.95	D
	1.50	0.56	Parlec	C40-02JT150-P	\$93.60	A
	2.44	0.56	Kingston	C40-02JT244-K	\$65.95	F
	2.44	0.56	Spin Tru	C40-02JT244-KB	\$65.95	D
JT3	1.50	-	Kingston	C40-03JT150-K	\$65.95	F
	1.50	-	Spin Tru	C40-03JT150-KB	\$65.95	D
	1.50	0.81	Parlec	C40-03JT150-P	\$93.60	A
	2.81	0.81	Kingston	C40-03JT281-K	\$65.95	F
JT4	1.50	-	Kingston	C40-04JT150-K	\$65.95	F
	1.50	-	Spin Tru	C40-04JT150-KB	\$65.95	D
	1.50	1.12	Parlec	C40-04JT150-P	\$120.60	A
	3.25	1.13	Kingston	C40-04JT325-K	\$65.95	F
	3.25	1.13	Spin Tru	C40-04JT325-KB	\$65.95	D
JT6	1.50	-	Kingston	C40-06JT150-K	\$65.95	F
	1.50	-	Spin Tru	C40-06JT150-KB	\$65.95	D
	1.50	0.68	Parlec	C40-06JT150-P	\$93.60	A
	3.25	0.68	Kingston	C40-06JT325-K	\$65.95	F
	3.25	0.68	Spin Tru	C40-06JT325-KB	\$65.95	D
JT33	1.50	-	Kingston	C40-33JT150-K	\$65.95	F
	1.50	0.62	Spin Tru	C40-33JT150-KB	\$65.95	D
	1.50	0.63	Parlec	C40-33JT150-P	\$93.60	A
	2.56	0.63	Kingston	C40-33JT256-K	\$65.95	F
	2.56	0.63	Spin Tru	C40-33JT256-KB	\$65.95	D

KEYLESS DRILL CHUCKS

With Integral Shank

- Integral shank precision ball-bearing keyless drill chuck offers greater accuracy and rigidity
- Made of alloy forged steel
- Self-tightening keyless operation
- Maximum TIR: 0.0015"
- Includes wrench



Taper	Capacity	Proj.	BISON Part Number	Price Each	TMX Part Number	Price Each
BT40	1/32"-1/2"	3.74	B40-50DC1-B	\$225.90	TMX-8230-4033	\$217.12
	1/8"-5/8"	3.94	B40-62DC1-B	\$243.90	TMX-8230-4035	\$233.89
CAT40	1/32"-1/2"	4.13	C40-50DC1-B	\$229.50	TMX-8130-4033	\$245.99
	1/8"-5/8"	5.12	C40-62DC1-B	\$246.60	TMX-8130-4035	\$263.93
CAT50	1/32"-1/2"	4.13	C50-50DC1-B	\$273.60	TMX-8130-5063	\$292.76
	1/8"-5/8"	4.33	C50-62DC1-B	\$290.70	TMX-8130-5065	\$310.79

MORSE TAPER HOLDERS

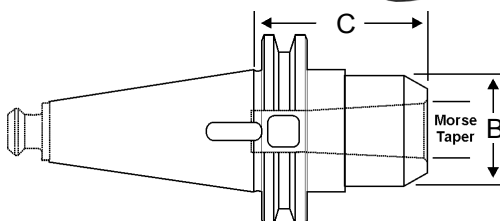

Morse Taper	C Proj	B Face Dia	Brand	Part Number	Price	Code
MT1	1.75	1.00	Kingston	C40-01MT175-K	\$65.95	F
	1.75	1.00	Spin Tru	C40-01MT175-KB	\$65.95	D
	1.75	1.75	Parlec	C40-01MT175-P	\$107.10	A
MT2	1.75	1.25	Kingston	C40-02MT175-K	\$65.95	F
	1.75	1.25	Spin Tru	C40-02MT175-KB	\$65.95	D
	1.75	1.75	Parlec	C40-02MT175-P	\$106.20	A
	2.44	1.25	Kingston	C40-02MT244-K	\$65.95	F
	2.44	1.25	Spin Tru	C40-02MT244-KB	\$65.95	D
MT3	2.50	1.75	Kingston	C40-03MT250-K	\$65.95	F
	2.50	1.75	Spin Tru	C40-03MT250-KB	\$65.95	D
	2.50	1.75	Parlec	C40-03MT250-P	\$119.70	A
	3.00	1.75	Kingston	C40-03MT300-K	\$62.65	F
	3.00	1.75	Spin Tru	C40-03MT300-KB	\$62.65	D
MT4	3.50	2.00	Kingston	C40-04MT350-K	\$62.65	F
	3.50	2.00	Spin Tru	C40-04MT350-KB	\$62.65	D
	3.50	2.00	Parlec	C40-04MT350-P	\$122.85	A
	3.88	2.00	Kingston	C40-04MT388-K	\$65.95	F

Call Us Today For All Of Your Machine Tool Needs!

CAT-40 V-FLANGE SHELL MILL HOLDERS

SHELL MILL HOLDERS

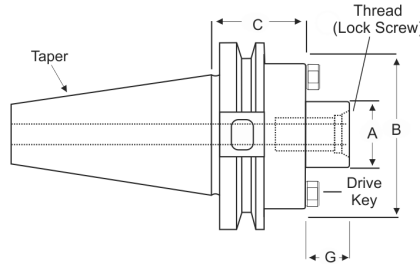

A Pilot dia	B Dia	C Proj	G	Brand	Part Number	Price	Drive Key	Screw Thread	Lock Screw	Arbor Screw	Code
1/2" 0.500	1.75	1.38	-	Kingston	C40-50SM138-K	\$65.95	-	-	-	-	F
	1.75	1.38	-	Spin Tru	C40-50SM138-KB	\$65.95	-	-	-	-	D
	1.38	1.75	0.57	Lyndex	C40-50SM175-L	\$153.90	1/4"	1/4"-28	-	A1/4-28	B
	1.75	3.50	-	Kingston	C40-50SM350-K	\$65.95	-	-	-	-	F
	1.75	3.50	-	Spin Tru	C40-50SM350-KB	\$65.95	-	-	-	-	D
3/4" 0.750	-	1.50	-	Kingston	C40-75SM150-K	\$65.95	-	-	-	-	F
	-	1.50	-	Spin Tru	C40-75SM150-KB	\$65.95	-	-	-	-	D
	1.75	1.50	0.68	Parlec	C40-75SM150-P	\$150.75	75KY	3/8"-24	-	028-192	A
	2.00	1.75	0.67	Lyndex	C40-75SM175-L	\$149.86	5/16"	3/8"-24	-	A3/8-24	B
	1.75	3.50	-	Kingston	C40-75SM350-K	\$65.95	-	-	-	-	F
	1.75	3.50	-	Spin Tru	C40-75SM350-KB	\$65.95	-	-	-	-	D
	-	4.00	-	Kingston	C40-75SM400-K	\$65.95	-	-	-	-	F
	-	4.00	-	Spin Tru	C40-75SM400-KB	\$65.95	-	-	-	-	D
	1.75	4.00	0.68	Parlec	C40-75SM400-P	\$167.40	75KY	3/8"-24	-	028-192	A
1.75	6.00	-	Kingston	C40-75SM600-K	\$71.45	-	-	-	-	F	
1" 1.000	-	1.15	-	Kingston	C40-10SM115-K	\$65.95	-	-	-	-	F
	-	1.15	-	Spin Tru	C40-10SM115-KB	\$65.95	-	-	-	-	D
	-	2.00	-	Kingston	C40-10SM200-K	\$65.95	-	-	-	-	F
	-	2.00	-	Spin Tru	C40-10SM200-KB	\$65.95	-	-	-	-	D
	2.25	2.00	0.68	Parlec	C40-10SM200-P	\$124.65	10KY	1/2"-20	10LS	028-188	A
	2.19	4.00	-	Kingston	C40-10SM400-K	\$65.95	-	-	-	-	F
	2.19	4.00	-	Spin Tru	C40-10SM400-KB	\$65.95	-	-	-	-	D
	2.19	6.00	-	Kingston	C40-10SM600-K	\$71.45	-	-	-	-	F
	2.19	6.00	-	Spin Tru	C40-10SM600-KB	\$71.45	-	-	-	-	D
2.38	4.00	0.67	Lyndex	C40-10SM400-L	\$180.50	3/8"	1/2"-20	-	A1/2-20	B	
1-1/4" 1.250	2.75	1.62	0.68	Parlec	C40-12SM162-P	\$130.50	12KY	5/8"-18	-	028-193	A
	2.88	2.00	0.67	Lyndex	C40-12SM200-L	\$152.10	1/2"	5/8"-18	-	A5/8-18	B
	2.88	2.12	-	Kingston	C40-12SM212-K	\$65.95	-	-	-	-	F
	2.75	2.25	0.68	Parlec	C40-12SM225-P	\$132.30	12KY	5/8"-18	12LS	028-193	A
	2.88	2.50	-	Kingston	C40-12SM250-K	\$65.95	-	-	-	-	F
	2.88	2.50	-	Spin Tru	C40-12SM250-KB	\$65.95	-	-	-	-	D
	2.75	4.00	0.68	Parlec	C40-12SM400-P	\$189.90	12KY	5/8"-18	12LS	028-193	A
	2.88	4.00	-	Kingston	C40-12SM400-K	\$65.95	-	-	-	-	F
	2.88	4.00	-	Spin Tru	C40-12SM400-KB	\$65.95	-	-	-	-	D
2.88	4.00	0.67	Lyndex	C40-12SM400-L	\$189.05	1/2"	5/8"-18	-	A5/8-18	B	
1-1/2" 1.500	3.75	2.40	0.94	Parlec	C40-15SM240-P	\$148.05	15KY	3/4"-16	15LS	15LS	A
	3.38	2.50	-	Kingston	C40-15SM250-K	\$65.95	-	-	-	-	F
	3.38	2.50	-	Spin Tru	C40-15SM250-KB	\$65.95	-	-	-	-	D
	3.38	4.00	-	Kingston	C40-15SM400-K	\$65.95	-	-	-	-	F
	3.38	4.00	-	Spin Tru	C40-15SM400-KB	\$65.95	-	-	-	-	D
	3.80	4.00	0.93	Lyndex	C40-15SM400-L	\$202.35	5/8"	3/4"-16	-	A3/4-16	B

90° MILLING CUTTERS

For Use With APKT/APGT1604 Series Inserts

CALL FOR OUR HOT MILLING SPECIALS!



Dia. D	Arbor Hole d	Key Width a	Flute Length H	No. of Flutes	Part Number	Price Each
2.00	0.750	0.3125	1.75	4	M-SAP16N-2075-4	\$195.00
2.00	0.750	0.3125	1.75	5	M-SAP16N-2075-5	\$195.00
2.50	1.000	0.3750	2.00	5	M-SAP16N-2510-5	\$199.00
3.00	1.000	0.3750	2.00	6	M-SAP16N-3010-6	\$310.00
3.00	1.000	0.3750	2.00	7	M-SAP16N-3010-7	\$310.00

Call Us Or Visit Our Website For Our Complete Selection!

LATHE CHUCKS
LIVE CENTERS

VICE JAWS
VICE ACCESSORIES

STRAIGHT SHANK
COLLET HOLDERS

TAP HOLDERS
DRILL CHUCKS

CARBIDE INSERTS
THREADING/GROOVING

CUTTING TOOLS
MACHINERY

PRECISION TOOLS
DEBURRING

COOLANT/FLUIDS
TOOL STORAGE