

ER COLLETS- ER 8, ER 11 & ER 16

Accu-Collets ER COLLETS

Accu-Collets

AccuCollets™ Precision and UltraPrecision Collets DIN 6499-form B (ER) set new standards of accuracy.

Precision Collets concentricity is 15 microns or 0.0005" TIR or better
Ultra Precision Collets is 6 microns or 0.0002" TIR or better

- Manufactured with Swiss technology
- Crafted from high quality European alloy spring steel
- **TRUE INCH** and metric sizes
- **Fractional Collets** manufactured specifically for US market requirements. Use "on size" collets for best results
- 16 slot construction for rigid clamping and extra concentricity
- Accu-Collets improve tool life, part finish, and reduce spindle wear
- Can be used for drilling, milling, tapping, and reaming



**PRICES
REDUCED!**

Precision ER Collets
0.0005" TIR or better as measured over the entire clamping range per DIN 6499 Standards

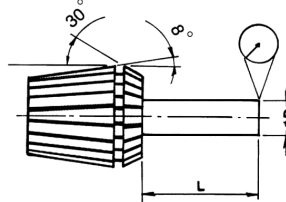

Clamping Range		Maximum TIR	
Collet Dia	L	DIN 6499/ISO 15488Form B	Accu-Collets Precision ER
0.039-0.063	0.236	0.0006"	0.0005"
0.063-0.118	0.394		
0.118-0.236	0.630		
0.236-0.394	0.984		
0.394-0.709	1.575	0.0008"	0.0005"
0.709-1.024	1.969		
1.024-1.339	2.362		
		0.0010"	0.0005"

Collapse For ER-16 Collets is .04" For Bore Sizes Above 1.5mm

					ER-8		ER-11		ER-16	
ON SIZE		Nominal Size			Precision	ULTRA PRECISION	Precision	ULTRA PRECISION	Precision	ULTRA PRECISION
Frac	MM	Dec.	Range	Nominal Sizes Covered	\$14.75 ea	\$21.00 ea	\$8.75 ea	\$21.00 ea	\$8.75 ea	\$21.00 ea
-	1.0	0.039	0.039-0.019	-	08-0039-1.0	08-0039-1.0UP	11-0039-1.0	11-0039-1.0UP	16-0039-1.0	16-0039-1.0UP
3/64	-	0.046	0.046-0.026	3/64	08-0046-3/64	08-0046-3/64UP	11-0046-3/64	11-0046-3/64UP	16-0046-3/64	16-0046-3/64UP
-	1.5	0.059	0.059-0.039	3/64	08-0059-1.5	08-0059-1.5UP	11-0059-1.5	11-0059-1.5UP	16-0059-1.5	16-0059-1.5UP
1/16	-	0.062	0.062-0.042	1/16, 3/64	08-0062-1/16	08-0062-1/16UP	11-0062-1/16	11-0062-1/16UP	16-0062-1/16	16-0062-1/16UP
5/64	-	0.078	0.078-0.058	5/64, 1/16	08-0078-5/64	08-0078-5/64UP	11-0078-5/64	11-0078-5/64UP	16-0078-5/64	16-0078-5/64UP
-	2.0	0.079	0.079-0.059	5/64, 1/16	08-0079-2.0	08-0079-2.0UP	11-0079-2.0	11-0079-2.0UP	16-0079-2.0	16-0079-2.0UP
3/32	-	0.093	0.093-0.073	3/32, 5/64	08-0093-3/32	08-0093-3/32UP	11-0093-3/32	11-0093-3/32UP	16-0093-3/32	16-0093-3/32UP
-	2.5	0.098	0.098-0.078	3/32	08-0098-2.5	08-0098-2.5UP	11-0098-2.5	11-0098-2.5UP	16-0098-2.5	16-0098-2.5UP
7/64	-	0.109	0.109-0.089	7/64, 3/32	08-0109-7/64	08-0109-7/64UP	11-0109-7/64	11-0109-7/64UP	16-0109-7/64	16-0109-7/64UP
-	3.0	0.118	0.118-0.098	7/64	08-0118-3.0	08-0118-3.0UP	11-0118-3.0	11-0118-3.0UP	16-0118-3.0	16-0118-3.0UP
1/8	-	0.125	0.125-0.105	1/8, 7/64	08-0125-1/8	08-0125-1/8UP	11-0125-1/8	11-0125-1/8UP	16-0125-1/8	16-0125-1/8UP
-	3.5	0.138	0.138-0.118	1/8	08-0138-3.5	08-0138-3.5UP	11-0138-3.5	11-0138-3.5UP	16-0138-3.5	16-0138-3.5UP
9/64	-	0.140	0.140-0.120	9/64, 1/8	08-0140-9/64	08-0140-9/64UP	11-0140-9/64	11-0140-9/64UP	16-0140-9/64	16-0140-9/64UP
5/32	-	0.156	0.156-0.136	5/32, 9/64	08-0156-5/32	08-0156-5/32UP	11-0156-5/32	11-0156-5/32UP	16-0156-5/32	16-0156-5/32UP
-	4.0	0.157	0.157-0.137	5/32, 9/64	08-0157-4.0	08-0157-4.0UP	11-0157-4.0	11-0157-4.0UP	16-0157-4.0	16-0157-4.0UP
11/64	-	0.171	0.171-0.151	11/64, 5/32	08-0171-11/64	08-0171-11/64UP	11-0171-11/64	11-0171-11/64UP	16-0171-11/64	16-0171-11/64UP
-	4.5	0.177	0.177-0.157	11/64	08-0177-4.5	08-0177-4.5UP	11-0177-4.5	11-0177-4.5UP	16-0177-4.5	16-0177-4.5UP
3/16	-	0.187	0.187-0.167	3/16, 11/64	08-0187-3/16	08-0187-3/16UP	11-0187-3/16	11-0187-3/16UP	16-0187-3/16	16-0187-3/16UP
-	5.0	0.196	0.196-0.176	3/16	08-0196-5.0	08-0196-5.0UP	11-0196-5.0	11-0196-5.0UP	16-0196-5.0	16-0196-5.0UP
13/64	-	0.203	0.203-0.183	13/64, 3/16	-	-	11-0203-13/64	11-0203-13/64UP	16-0203-13/64	16-0203-13/64UP
-	5.5	0.217	0.217-0.197	13/64	-	-	11-0217-5.5	11-0217-5.5UP	16-0217-5.5	16-0217-5.5UP
7/32	-	0.218	0.218-0.198	7/32, 13/64	-	-	11-0218-7/32	11-0218-7/32UP	16-0218-7/32	16-0218-7/32UP
15/64	-	0.234	0.234-0.214	15/64, 7/32	-	-	11-0234-15/64	11-0234-15/64UP	16-0234-15/64	16-0234-15/64UP
-	6.0	0.236	0.236-0.216	15/64, 7/32	-	-	11-0236-6.0	11-0236-6.0UP	16-0236-6.0	16-0236-6.0UP
1/4	-	0.250	0.250-0.230	1/4, 15/64	-	-	11-0250-1/4	11-0250-1/4UP	16-0250-1/4	16-0250-1/4UP
-	6.5	0.256	0.256-0.236	1/4	-	-	11-0256-6.5	11-0256-6.5UP	16-0256-6.5	16-0256-6.5UP
17/64	-	0.265	0.265-0.245	17/64, 1/4	-	-	11-0265-17/64	11-0265-17/64UP	16-0265-17/64	16-0265-17/64UP
-	7.0	0.275	0.275-0.255	17/64	-	-	11-0275-7.0	11-0275-7.0UP	16-0275-7.0	16-0275-7.0UP
9/32	-	0.281	0.281-0.242	9/32, 17/64	-	-	-	-	16-0281-9/32	16-0281-9/32UP
-	7.5	0.295	0.295-0.256	9/32, 17/64	-	-	-	-	16-0295-7.5	16-0295-7.5UP
19/64	-	0.296	0.296-0.257	19/64, 9/32	-	-	-	-	16-0296-19/64	16-0296-19/64UP
5/16	-	0.312	0.312-0.273	5/16, 19/64, 9/32	-	-	-	-	16-0312-5/16	16-0312-5/16UP
-	8.0	0.315	0.315-0.276	5/16, 19/64	-	-	-	-	16-0315-8.0	16-0315-8.0UP
21/64	-	0.328	0.328-0.289	21/64, 5/16, 19/64	-	-	-	-	16-0328-21/64	16-0328-21/64UP
-	8.5	0.335	0.334-0.295	21/64, 5/16	-	-	-	-	16-0334-8.5	16-0334-8.5UP
11/32	-	0.343	0.343-0.304	11/32, 21/64	-	-	-	-	16-0343-11/32	16-0343-11/32UP
-	9.0	0.354	0.354-0.315	11/32, 21/64	-	-	-	-	16-0354-9.0	16-0354-9.0UP
23/64	-	0.359	0.359-0.320	23/64, 11/32	-	-	-	-	16-0359-23/64	16-0359-23/64UP
-	9.5	0.374	0.374-0.335	23/64, 11/32	-	-	-	-	16-0374-9.5	16-0374-9.5UP
3/8	-	0.375	0.375-0.336	3/8, 23/64	-	-	-	-	16-0375-3/8	16-0375-3/8UP
25/64	-	0.390	0.390-0.351	25/64, 3/8, 23/64	-	-	-	-	16-0390-25/64	16-0390-25/64UP
-	10.0	0.394	0.393-0.354	25/64, 3/8	-	-	-	-	16-0393-10.0	16-0393-10.0UP

Call Us Today For All Of Your Machine Tool Needs!

ER COLLETS



- Concentricity is 13 microns or 0.0005" TIR or better
- Manufactured with Swiss technology
- Crafted from high quality European alloy spring steel
- **TRUE INCH** and metric sizes
- **Fractional Collets** manufactured specifically for US market requirements
- 16 slot construction for rigid clamping and extra concentricity
- Accu-Collets improve tool life, part finish, and reduce spindle wear
- Can be used for drilling, milling, tapping, and reaming

PRICES REDUCED!

Accu-Collets

Precision ER Collets
0.0005" TIR or better as measured over the entire clamping range per DIN 6499 Standards

LATHE CHUCKS
LIVE CENTERS
VISE ACCESSORIES
VISE JAWS
STRAIGHT SHANK COLLET HOLDERS
TAP HOLDERS
DRILL CHUCKS
CARBIDE INSERTS
THREADING/GROOVING
CUTTING TOOLS
MACHINERY
PRECISION TOOLS
DEBURRING
COOLANT/FLUIDS
TOOL STORAGE

					ER 20		ER 25	
ON SIZE		Nominal Size			Precision	UltraPrecision	Precision	UltraPrecision
Frac	MM	Dec.	Inch Range	Nominal Sizes Covered	\$9.75 ea	\$23.00 ea	\$9.75 ea	\$23.00 ea
-	1.0	0.039	0.039-0.019	13/32	20-0039-1.0	20-0039-1.0UP	-	-
3/64	-	0.046	0.046-0.026	3/64	20-0046-3/64	20-0046-3/64UP	-	-
1/16	-	0.062	0.062-0.042	1/16, 3/64	20-0062-1/16	20-0062-1/16UP	25-0062-1/16	-
5/64	-	0.078	0.078-0.058	5/64, 1/16	20-0078-5/64	20-0078-5/64UP	25-0078-5/64	25-0078-5/64UP
-	2.0	0.079	0.079-0.040	5/64, 1/16	20-0079-2.0	20-0079-2.0UP	25-0079-2.0	25-0079-2.0UP
3/32	-	0.093	0.093-0.054	3/32, 5/64, 1/16	20-0093-3/32	20-0093-3/32UP	25-0093-3/32	25-0093-3/32UP
7/64	-	0.109	0.109-0.089	7/64, 3/32	20-0109-7/64	20-0109-7/64UP	25-0109-7/64	25-0109-7/64UP
-	3.0	0.118	0.118-0.079	7/64, 3/32	20-0118-3.0	20-0118-3.0UP	25-0118-3.0	25-0118-3.0UP
1/8	-	0.125	0.125-0.086	1/8, 7/64	20-0125-1/8	20-0125-1/8UP	25-0125-01/8	25-0125-01/8UP
9/64	-	0.140	0.140-0.120	9/64, 1/8	20-0140-9/64	20-0140-9/64UP	25-0140-9/64	25-0140-9/64UP
5/32	-	0.156	0.156-0.117	5/32, 9/64, 1/8	20-0156-5/32	20-0156-5/32UP	25-0156-5/32	25-0156-5/32UP
-	4.0	0.157	0.157-0.118	5/32, 9/64	20-0157-4.0	20-0157-4.0UP	25-0157-4.0	25-0157-4.0UP
11/64	-	0.171	0.171-0.151	11/64, 5/32	20-0171-11/64	20-0171-11/64UP	25-0171-11/64	25-0171-11/64UP
3/16	-	0.187	0.187-0.148	3/16, 11/64	20-0187-3/16	20-0187-3/16UP	25-0187-3/16	25-0187-3/16UP
-	5.0	0.196	0.196-0.157	3/16, 11/64	20-0196-5.0	20-0196-5.0UP	25-0196-5.0	25-0196-5.0UP
13/64	-	0.203	0.203-0.183	13/64, 3/16	20-0203-13/64	20-0203-13/64UP	25-0203-13/64	25-0203-13/64UP
7/32	-	0.218	0.218-0.179	7/32, 13/64	20-0218-7/32	20-0218-7/32UP	25-0218-7/32	25-0218-7/32UP
15/64	-	0.234	0.234-0.214	15/64, 7/32	20-0234-15/64	20-0234-15/64UP	25-0234-15/64	25-0234-15/64UP
-	6.0	0.236	0.236-0.197	15/64, 7/32	20-0236-6.0	20-0236-6.0UP	25-0236-6.0	25-0236-6.0UP
1/4	-	0.250	0.250-0.211	1/4, 15/64, 7/32	20-0250-1/4	20-0250-1/4UP	25-0250-1/4	25-0250-1/4UP
17/64	-	0.265	0.265-0.245	17/64, 1/4	20-0265-17/64	20-0265-17/64UP	25-0265-17/64	25-0265-17/64UP
-	7.0	0.275	0.275-0.236	17/64, 1/4	20-0275-7.0	20-0275-7.0UP	25-0275-7.0	25-0275-7.0UP
9/32	-	0.281	0.281-0.242	9/32, 17/64	20-0281-9/32	20-0281-9/32UP	25-0281-9/32	25-0281-9/32UP
19/64	-	0.296	0.296-0.257	19/64, 9/32	20-0296-19/64	20-0296-19/64UP	25-0296-19/64	25-0296-19/64UP
5/16	-	0.312	0.312-0.273	5/16, 19/64, 9/32	20-0312-5/16	20-0312-5/16UP	25-0312-5/16	25-0312-5/16UP
-	8.0	0.315	0.315-0.276	5/16, 19/64	20-0315-8.0	20-0315-8.0UP	25-0315-8.0	25-0315-8.0UP
21/64	-	0.328	0.328-0.289	21/64, 5/16, 19/64	20-0328-21/64	20-0328-21/64UP	25-0328-21/64	25-0328-21/64UP
11/32	-	0.343	0.343-0.304	11/32, 21/64	20-0343-11/32	20-0343-11/32UP	25-0343-11/32	25-0343-11/32UP
-	9.0	0.354	0.354-0.315	11/32, 21/64	20-0354-9.0	20-0354-9.0UP	25-0354-9.0	25-0354-9.0UP
23/64	-	0.359	0.359-0.320	23/64, 11/32	20-0359-23/64	20-0359-23/64UP	25-0359-23/64	25-0359-23/64UP
3/8	-	0.375	0.375-0.336	3/8, 23/64	20-0375-3/8	20-0375-3/8UP	25-0375-3/8	25-0375-3/8UP
25/64	-	0.390	0.390-0.351	25/64, 3/8, 23/64	20-0390-25/64	20-0390-25/64UP	25-0390-25/64	25-0390-25/64UP
-	10.0	0.393	0.393-0.354	25/64, 3/8	20-0393-10.0	20-0393-10.0UP	25-0393-10.0	25-0393-10.0UP
13/32	-	0.406	0.406-0.367	13/32, 25/64, 3/8	20-0406-13/32	20-0406-13/32UP	25-0406-13/32	25-0406-13/32UP
27/64	-	0.421	0.421-0.382	27/64, 13/32	20-0421-27/64	20-0421-27/64UP	25-0421-27/64	25-0421-27/64UP
-	11.0	0.433	0.433-0.394	27/64, 13/32	20-0433-11.0	20-0433-11.0UP	25-0433-11.0	25-0433-11.0UP
7/16	-	0.437	0.437-0.398	7/16, 27/64	20-0437-7/16	20-0437-7/16UP	25-0437-7/16	25-0437-7/16UP
29/64	-	0.453	0.453-0.414	29/64, 7/16	20-0453-29/64	20-0453-29/64UP	25-0453-29/64	25-0453-29/64UP
15/32	-	0.468	0.468-0.429	15/32, 29/64, 7/16	20-0468-15/32	20-0468-15/32UP	25-0468-15/32	25-0468-15/32UP
-	12.0	0.472	0.472-0.433	15/32, 29/64	20-0472-12.0	20-0472-12.0UP	25-0472-12.0	25-0472-12.0UP
31/64	-	0.484	0.484-0.445	31/64, 15/32	20-0484-31/64	20-0484-31/64UP	25-0484-31/64	25-0484-31/64UP
1/2	-	0.500	0.500-0.461	1/2, 31/64	20-0500-1/2	20-0500-1/2UP	25-0500-1/2	25-0500-1/2UP
-	13.0	0.511	0.511-0.472	1/2, 31/64	20-0511-13.0	20-0511-13.0UP	25-0511-13.0	25-0511-13.0UP
33/64	-	0.515	0.515-0.476	33/64, 1/2	-	-	25-0515-33/64	25-0515-33/64UP
17/32	-	0.531	0.531-0.492	17/32, 33/64	-	-	25-0531-17/32	25-0531-17/32UP
35/64	-	0.546	0.546-0.507	35/64, 17/32	-	-	25-0546-35/64	25-0546-35/64UP
-	14.0	0.551	0.551-0.512	35/64, 17/32	-	-	25-0551-14.0	25-0551-14.0UP
9/16	-	0.563	0.562-0.523	9/16, 35/64, 17/32	-	-	25-0562-9/16	25-0562-9/16UP
37/64	-	0.578	0.578-0.539	37/64, 9/16	-	-	25-0578-37/64	25-0578-37/64UP
-	15.0	0.591	0.590-0.551	37/64, 9/16	-	-	25-0590-15.0	25-0590-15.0UP
19/32	-	0.594	0.593-0.554	19/32, 37/64	-	-	25-0593-19/32	25-0593-19/32UP
39/64	-	0.609	0.609-0.570	39/64, 19/32	-	-	25-0609-39/64	25-0609-39/64UP
5/8	-	0.625	0.625-0.586	5/8, 39/64, 19/32	-	-	25-0625-05/8	25-0625-05/8UP
-	16.0	0.630	0.630-0.591	5/8, 39/64	-	-	25-0630-16.0	25-0630-16.0UP

Call Us Or Visit Our Website For Our Complete Selection!

ER COLLETS- ER 32 & ER 40

ER COLLETS

- Concentricity is 13 microns or 0.0005" TIR or better
- Manufactured with Swiss technology
- Crafted from high quality European alloy spring steel
- **TRUE INCH** and metric sizes
- **Fractional Collets** manufactured specifically for US market requirements
- 16 slot construction for rigid clamping and extra concentricity
- Accu-Collets improve tool life, part finish, and reduce spindle wear
- Can be used for drilling, milling, tapping, and reaming



**PRICES
REDUCED!**

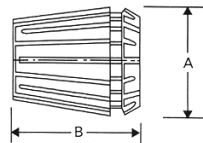

Accu-Collets

ER COLLET DIMENSIONS

Collet Series	A	B
ER 8	8.5mm (.335 in)	13.5mm (.531 in)
ER 11	11.5mm (.453 in)	18mm (.709 in)
ER 16	17mm (.669 in)	27mm (1.063 in)
ER 20	21mm (.827 in)	31mm (1.220 in)
ER 25	26mm (1.024 in)	35mm (1.378 in)
ER 32	33mm (1.299 in)	40mm (1.575 in)
ER 40	41mm (1.614 in)	46mm (1.811 in)

					ER 32	
On Size		Nominal Size			Precision	Ultra Precision
Frac	MM	Dec.	Inch Range	Nominal Sizes Covered	\$10.25 ea	\$24.00 ea
3/64	-	0.047	0.046-0.026	3/64, 1/16, 5/64	32-0047-3/64	-
1/16	-	0.062	0.062-0.042	1/16, 3/64	32-0063-1/16	-
5/64	-	0.078	0.078-0.058	5/64, 3/32, 7/64	32-0078-5/64	-
3/32	-	0.093	0.093-0.054	3/32, 5/64, 1/16	32-0093-3/32	32-0093-3/32UP
-	2.5	0.098	0.098-0.079	7/64, 1/8,	32-0098-2.5	32-0098-2.5UP
7/64	-	0.109	0.109-0.089	7/64, 1/8,	32-0109-7/64	32-0109-7/64UP
-	3.0	0.118	0.118-0.079	7/64, 3/32	32-0118-3.0	32-0118-3.0UP
1/8	-	0.125	0.125-0.085	1/8, 7/64	32-0125-1/8	32-0125-1/8UP
-	3.5	0.138	0.138-0.118	5/32, 11/64	32-0138-3.5	32-0138-3.5UP
9/64	-	0.141	0.140-0.120	5/32, 11/64	32-0140-9/64	32-0140-9/64UP
5/32	-	0.156	0.156-0.117	5/32, 9/64, 1/8	32-0156-5/32	32-0156-5/32UP
-	4.0	0.157	0.157-0.118	5/32, 9/64	32-0157-4.0	32-0157-4.0UP
11/64	-	0.172	0.171-0.151	3/16, 13/64	32-0171-11/64	32-0171-11/64UP
-	4.5	0.177	0.177-0.158	3/16, 13/64	32-0177-4.5	32-0177-4.5UP
3/16	-	0.187	0.187-0.148	3/16, 11/64	32-0187-3/16	32-0187-3/16UP
-	5.0	0.196	0.196-0.157	3/16, 11/64	32-0196-5.0	32-0196-5.0UP
13/64	-	0.203	0.203-0.183	13/64, 7/32, 15/64	32-0203-13/64	32-0203-13/64UP
-	5.5	0.217	0.217-0.197	7/32, 15/64, 1/4	32-0216-5.5	32-0217-5.5UP
7/32	-	0.218	0.218-0.179	7/32, 13/64	32-0218-7/32	32-0218-7/32UP
15/64	-	0.234	0.234-0.214	15/64, 1/4, 17/64	32-0234-15/64	32-0234-15/64UP
-	6.0	0.236	0.236-0.197	15/64, 7/32	32-0236-6.0	32-0236-6.0UP
1/4	-	0.250	0.250-0.211	1/4, 15/64, 7/32	32-0250-1/4	32-0250-1/4UP
-	6.5	0.256	0.256-0.236	17/64, 9/32	32-0256-6.5	32-0256-6.5UP
17/64	-	0.266	0.265-0.245	9/32, 19/64	32-0265-17/64	32-0265-17/64UP
-	7.0	0.275	0.275-0.236	17/64, 1/4	32-0275-7.0	32-0275-7.0UP
9/32	-	0.281	0.281-0.242	9/32, 17/64	32-0281-9/32	32-0281-9/32UP
-	7.5	0.295	0.295-0.256	19/64, 5/16, 21/64	32-0296-7.5	32-0296-7.5UP
19/64	-	0.297	0.296-0.257	5/16, 21/64	32-0296-19/64	32-0296-19/64UP
5/16	-	0.312	0.312-0.273	5/16, 19/64, 9/32	32-0312-5/16	32-0312-5/16UP
-	8.0	0.315	0.315-0.276	5/16, 19/64	32-0315-8.0	32-0315-8.0UP
21/64	-	0.328	0.328-0.289	21/64, 11/32, 23/64	32-0328-21/64	32-0328-21/64UP
-	8.5	0.335	0.335-0.295	11/32, 23/64	32-0334-8.5	32-0334-8.5UP
11/32	-	0.343	0.343-0.304	11/32, 21/64	32-0343-11/32	32-0343-11/32UP
-	9.0	0.354	0.354-0.315	11/32, 21/64	32-0354-9.0	32-0354-9.0UP
23/64	-	0.359	0.359-0.320	23/64, 3/8, 25/64	32-0359-23/64	32-0359-23/64UP
3/8	-	0.375	0.375-0.336	3/8, 23/64	32-0375-3/8	32-0375-3/8UP
25/64	-	0.391	0.390-0.351	13/32, 27/64	32-0390-25/64	32-0390-25/64UP
-	10.0	0.393	0.393-0.354	25/64, 3/8	32-0393-10.0	32-0393-10.0UP
13/32	-	0.406	0.406-0.367	13/32, 25/64, 3/8	32-0406-13/32	32-0406-13/32UP
-	10.5	0.413	0.413-0.374	27/64, 7/16	32-0413-10.5	32-0413-10.5UP
27/64	-	0.422	0.421-0.382	7/16, 29/64	32-0421-27/64	32-0421-27/64UP
-	11.0	0.433	0.433-0.394	27/64, 13/32	32-0433-11.0	32-0433-11.0UP
7/16	-	0.437	0.437-0.398	7/16, 27/64	32-0437-7/16	32-0437-7/16UP
29/64	-	0.453	0.453-0.414	29/64, 15/32, 31/64	32-0453-29/64	32-0453-29/64UP
15/32	-	0.468	0.468-0.429	15/32, 29/64, 7/16	32-0468-15/32	32-0468-15/32UP
-	12.0	0.472	0.472-0.433	15/32, 29/64	32-0472-12.0	32-0472-12.0UP
31/64	-	0.484	0.484-0.445	31/64, 1/2, 33/64	32-0484-31/64	32-0484-31/64UP
-	12.5	0.492	0.492-0.453	1/2, 33/64	32-0492-12.5	32-0492-12.5UP
1/2	-	0.500	0.500-0.461	1/2, 31/64	32-0500-1/2	32-0500-1/2UP
-	13.0	0.511	0.511-0.472	1/2, 31/64	32-0511-13.0	32-0511-13.0UP
33/64	-	0.516	0.515-0.476	17/32, 35/64	32-0515-33/64	32-0515-33/64UP
17/32	-	0.531	0.531-0.492	17/32, 33/64	32-0531-17/32	32-0531-17/32UP

		ER 40	
		Precision	Ultra Precision
		\$11.25 ea	\$26.00 ea
40-0047-3/64	-	-	-
40-0063-1/16	-	-	-
40-0078-5/64	-	-	-
40-0094-3/32	-	-	-
40-0098-2.5	-	-	-
40-0109-7/64	-	-	-
40-0118-3.0	-	-	-
40-0125-1/8	40-0125-1/8UP	-	-
40-0138-3.5	40-0138-3.5UP	-	-
40-0140-9/64	40-0140-9/64UP	-	-
40-0156-5/32	40-0156-5/32UP	-	-
40-0157-4.0	40-0157-4.0UP	-	-
40-0171-11/64	40-0171-11/64UP	-	-
40-0177-4.5	40-0177-4.5UP	-	-
40-0187-3/16	40-0187-3/16UP	-	-
40-0196-5.0	40-0196-5.0UP	-	-
40-0203-13/64	40-0203-13/64UP	-	-
40-0216-5.5	40-0217-5.5UP	-	-
40-0218-7/32	40-0218-7/32UP	-	-
40-0234-15/64	40-0234-15/64UP	-	-
40-0236-6.0	40-0236-6.0UP	-	-
40-0250-1/4	40-0250-1/4UP	-	-
40-0256-6.5	40-0256-6.5UP	-	-
40-0265-17/64	40-0265-17/64UP	-	-
40-0275-7.0	40-0275-7.0UP	-	-
40-0281-9/32	40-0281-9/32UP	-	-
40-0296-7.5	40-0296-7.5UP	-	-
40-0296-19/64	40-0296-19/64UP	-	-
40-0312-5/16	40-0312-5/16UP	-	-
40-0315-8.0	40-0315-8.0UP	-	-
40-0328-21/64	40-0328-21/64UP	-	-
40-0334-8.5	40-0334-8.5UP	-	-
40-0343-11/32	40-0343-11/32UP	-	-
40-0354-9.0	40-0354-9.0UP	-	-
40-0359-23/64	40-0359-23/64UP	-	-
40-0375-3/8	40-0375-3/8UP	-	-
40-0390-25/64	40-0390-25/64UP	-	-
40-0393-10.0	40-0393-10.0UP	-	-
40-0406-13/32	40-0406-13/32UP	-	-
40-0413-10.5	40-0413-10.5UP	-	-
40-0421-27/64	40-0421-27/64UP	-	-
40-0433-11.0	40-0433-11.0UP	-	-
40-0437-7/16	40-0437-7/16UP	-	-
40-0453-29/64	40-0453-29/64UP	-	-
40-0468-15/32	40-0468-15/32UP	-	-
40-0472-12.0	40-0472-12.0UP	-	-
40-0484-31/64	40-0484-31/64UP	-	-
40-0492-12.5	40-0492-12.5UP	-	-
40-0500-1/2	40-0500-1/2UP	-	-
40-0511-13.0	40-0511-13.0UP	-	-
40-0515-33/64	40-0515-33/64UP	-	-
40-0531-17/32	40-0531-17/32UP	-	-

35/64 to 26mm ER 32 & 40 Collets Continued on Following Page

Call Us Today For All Of Your Machine Tool Needs!

ER COLLETS (continued from previous page)



- Concentricity is 13 microns or 0.0005" TIR or better
- Manufactured with Swiss technology
- Crafted from high quality European alloy spring steel
- **TRUE INCH** and metric sizes
- **Fractional Collets** manufactured specifically for US market requirements
- 16 slot construction for rigid clamping and extra concentricity
- Accu-Collets improve tool life, part finish and reduces spindle wear
- Can be used for drilling, milling, tapping and reaming

PRICES REDUCED!

Accu-Collets

Precision ER Collets
0.0005" TIR or better as measured over the entire clamping range per DIN 6499 Standards

On Size		Nominal Size			ER 32		ER 40	
Frac	MM	Dec.	Inch Range	Nominal Sizes Covered	Precision \$10.25 ea	Ultra Precision \$24.00 ea	Precision \$11.25 ea	Ultra Precision \$26.00 ea
35/64	-	0.547	0.546-0.507	9/16, 37/64	32-0546-35/64	32-0546-35/64UP	40-0546-35/64	40-0546-35/64UP
-	14.0	0.551	0.551-0.512	35/64, 17/32	32-0551-14.0	32-0551-14.0UP	40-0551-14.0	40-0551-14.0UP
9/16	-	0.562	0.562-0.523	9/16, 35/64, 17/32	32-0562-9/16	32-0562-9/16UP	40-0562-9/16	40-0562-9/16UP
-	14.5	0.571	0.571-0.532	37/64, 19/32, 39/64	32-0570-14.5	32-0570-14.5UP	40-0570-14.5	40-0570-14.5UP
37/64	-	0.578	0.578-0.539	37/64, 19/32, 39/64	32-0578-37/64	32-0578-37/64UP	40-0578-37/64	40-0578-37/64UP
-	15.0	0.590	0.590-0.551	37/64, 9/16	32-0590-15.0	32-0590-15.0UP	40-0590-15.0	40-0590-15.0UP
19/32	-	0.593	0.593-0.554	19/32, 37/64	32-0593-19/32	32-0593-19/32UP	40-0593-19/32	40-0593-19/32UP
39/64	-	0.609	0.609-0.570	39/64, 5/8, 41/64	32-0609-39/64	32-0609-39/64UP	40-0609-39/64	40-0609-39/64UP
-	15.5	0.610	0.601-0.571	5/8, 41/64	32-0610-15.5	32-0610-15.5UP	40-0610-15.5	40-0610-15.5UP
5/8	-	0.625	0.625-0.586	5/8, 39/64, 19/32	32-0625-5/8	32-0625-5/8UP	40-0625-5/8	40-0625-5/8UP
-	16.0	0.630	0.630-0.591	5/8, 39/64	32-0630-16.0	32-0630-16.0UP	40-0630-16.0	40-0630-16.0UP
41/64	-	0.641	0.641-0.602	21/32, 43/64	32-0640-41/64	32-0640-41/64UP	40-0640-41/64	40-0640-41/64UP
-	16.5	0.650	0.650-0.610	21/32, 43/64, 11/16	32-0650-16.5	32-0650-16.5UP	40-0650-16.5	40-0650-16.5UP
21/32	-	0.656	0.656-0.617	21/32, 41/64	32-0656-21/32	32-0656-21/32UP	40-0656-21/32	40-0656-21/32UP
-	17.0	0.669	0.669-0.630	21/32, 41/64	32-0669-17.0	32-0669-17.0UP	40-0669-17.0	40-0669-17.0UP
43/64	-	0.672	0.672-0.633	11/16, 46/64	32-0671-43/64	32-0671-43/64UP	40-0671-43/64	40-0671-43/64UP
11/16	-	0.687	0.687-0.648	11/16, 43/64, 21/32	32-0687-11/16	32-0687-11/16UP	40-0687-11/16	40-0687-11/16UP
-	17.5	0.689	0.689-0.650	45/64, 23/32	32-0689-17.5	32-0689-17.5UP	40-0689-17.5	40-0689-17.5UP
45/64	-	0.703	0.703-0.664	45/64, 23/32, 47/64	32-0703-45/64	32-0703-45/64UP	40-0703-45/64	40-0703-45/64UP
-	18.0	0.708	0.708-0.669	45/64, 11/16	32-0708-18.0	32-0708-18.0UP	40-0708-18.0	40-0708-18.0UP
23/32	-	0.718	0.718-0.679	23/32, 45/64	32-0718-23/32	32-0718-23/32UP	40-0718-23/32	40-0718-23/32UP
-	18.5	0.728	0.728-0.689	47/64, 3/4, 49/64	32-0728-18.5	32-0728-18.5UP	40-0728-18.5	40-0728-18.5UP
47/64	-	0.734	0.734-0.695	47/64, 3/4, 49/64	32-0734-47/64	32-0734-47/64UP	40-0734-47/64	40-0734-47/64UP
-	19.0	0.748	0.748-0.709	47/64, 23/32	32-0748-19.0	32-0748-19.0UP	40-0748-19.0	40-0748-19.0UP
3/4	-	0.750	0.750-0.711	3/4, 47/64	32-0750-3/4	32-0750-3/4UP	40-0750-3/4	40-0750-3/4UP
49/64	-	0.766	0.766-0.727	25/32, 51/64	32-0765-49/64	32-0765-49/64UP	40-0765-49/64	40-0765-49/64UP
-	19.5	0.768	0.768-0.728	25/32, 51/64	32-0767-19.5	32-0767-19.5UP	40-0767-19.5	40-0767-19.5UP
25/32	-	0.781	0.781-0.742	25/32, 49/64, 3/4	32-0781-25/32	32-0781-25/32UP	40-0781-25/32	40-0781-25/32UP
-	20.0	0.787	0.787-0.748	25/32, 49/64	32-0787-20.0	32-0787-20.0UP	40-0787-20.0	40-0787-20.0UP
51/64	-	0.797	0.797-0.758	51/64, 13/16, 53/64	32-0796-51/64	32-0796-51/64UP	40-0796-51/64	40-0796-51/64UP
-	20.5	0.807	0.807-0.768	13/16, 53/64, 37/32	32-0807-20.5	32-0807-20.5UP	40-0807-20.5	40-0807-20.5UP
13/16	-	0.813	0.813-0.783	13/16, 53/64, 37/32	32-0812-13/16	32-0812-13/16UP	40-0812-13/16	40-0812-13/16UP
-	21.0	0.826	0.826-0.787	13/16, 51/64	-	-	40-0826-21.0	40-0826-21.0UP
53/64	-	0.828	0.828-0.789	53/64, 37/32, 55/64	-	-	40-0828-53/64	40-0828-53/64UP
27/32	-	0.843	0.843-0.804	27/32, 53/64, 13/16	-	-	40-0843-27/32	40-0843-27/32UP
-	21.5	0.846	0.846-0.807	55/64, 7/8	-	-	40-0846-21.5	40-0846-21.5UP
55/64	-	0.859	0.859-0.820	55/64, 7/8, 57/64	-	-	40-0859-55/64	40-0859-55/64UP
-	22.0	0.866	0.866-0.827	55/64, 27/32	-	-	40-0866-22.0	40-0866-22.0UP
7/8	-	0.875	0.875-0.836	7/8, 55/64	-	-	40-0875-7/8	40-0875-7/8UP
-	22.5	0.886	0.886-0.847	57/64, 29/32	-	-	40-0886-22.5	40-0886-22.5UP
57/64	-	0.891	0.891-0.852	57/64, 29/32, 59/64	-	-	40-0890-57/64	40-0890-57/64UP
-	23.0	0.905	0.905-0.866	57/64, 7/8	-	-	40-0905-23.0	40-0905-23.0UP
29/32	-	0.906	0.906-0.867	29/32, 57/64	-	-	40-0906-29/32	40-0906-29/32UP
59/64	-	0.922	0.922-0.883	59/64, 15/16, 61/64	-	-	40-0921-59/64	40-0921-59/64UP
-	23.5	0.925	0.925-0.886	15/16, 61/64	-	-	40-0925-23.5	40-0925-23.5UP
15/16	-	0.937	0.937-0.898	15/16, 59/64, 29/32	-	-	40-0937-15/16	40-0937-15/16UP
-	24.0	0.944	0.944-0.905	15/16, 59/64	-	-	40-0944-24.0	40-0944-24.0UP
61/64	-	0.953	0.953-0.911	61/64, 31/32, 63/64	-	-	40-0953-61/64	40-0953-61/64UP
-	24.5	0.965	0.965-0.925	31/32, 63/64, 1	-	-	40-0965-24.5	40-0965-24.5UP
31/32	-	0.968	0.968-0.929	31/32, 61/64	-	-	40-0968-31/32	40-0968-31/32UP
-	25.0	0.984	0.984-0.945	31/32, 61/64	-	-	40-0984-25.0	40-0984-25.0UP
63/64	-	0.984	0.984-0.945	63/64, 1, 1-1/64	-	-	40-0985-63/64	40-0985-63/64UP
1"	-	1.000	1.000-0.961	1. 63/64, 31/32	-	-	40-1000-1-IN	40-1000-1-INUP
1-1/64	-	1.016	1.016-0.977	1-1/64, 63/64	-	-	40-1016-1-1/64	40-1016-1-1/64UP
-	26.0	1.024	1.024-0.984	1-1/64	-	-	40-1024-26.0	40-1024-26.0UP

LATHE CHUCKS
LIVE CENTERS
VISE ACCESSORIES
VISE JAWS
STRAIGHT SHANK COLLET HOLDERS
TAP HOLDERS
DRILL CHUCKS
CARBIDE INSERTS
THREADING/GROOVING
CUTTING TOOLS
MACHINERY
PRECISION TOOLS
DEBRUISING
COOLANT/FLUIDS
TOOL STORAGE

Call Us Or Visit Our Website For Our Complete Selection!

ER COLLET SETS/COOLANT COLLETS

ER COLLET SETS INCH & METRIC SIZES

AccuCollets™ Precision Collets DIN 6499-form B (ER) set new standards of accuracy. **Precision Collets** concentricity is 15 microns or 0.0005" TIR or better.

- Available in inch and metric sizes
- Additional combinations and ultra precision sets also available

Accu-Collets

**PRICES
REDUCED!**



Type	Style	Description	No. Of Collets	Part Number	Set Price
ER-8	Metric	1mm to 5mm x .5mm	9	08-SET9	\$118.00
	Inch	1/16"-3/16" x 1/64	9	08-SET9-INCH	\$118.00
ER-11	Metric	1mm to 7mm x .5mm	13	11-SET13	\$105.00
	Inch	1/16"-1/4" x 1/32	7	11-SET7-INCH	\$52.50
ER-16	Metric	1mm to 10mm x 1mm	10	16-SET10	\$78.75
	Inch	1/16" - 3/8" x 1/32"	11	16-SET11-INCH	\$87.50
ER-20	Metric	1mm to 13mm x 1mm	12	20-SET12	\$107.25
	Inch	1/16" - 1/2" x 1/32"	15	20-SET15-INCH	\$136.50
ER-25	Metric	2mm to 16mm x 1mm	15	25-SET15	\$136.50
	Inch	3/32" - 5/8" x 1/32"	18	25-SET18-INCH	\$165.75
ER-32	Metric	3mm to 20mm x 1mm	18	32-SET18	\$174.25
	Inch	1/8"-3/4" x 1/32"	21	32-SET21-INCH	\$205.00
ER-40	Metric	4mm to 26mm x 1mm	23	40-SET23	\$247.50
	Inch	1/8"-1" x 1/16"	15	40-SET15-INCH	\$157.50
	Inch	1/8" - 1" x 1/32"	29	40-SET29-INCH	\$315.00

COLLET TRAYS

- High impact plastic tray will not damage accurate locating surfaces
- Sliding see thru plastic cover
- Up to 40 collets per tray - holds a full set plus special & metric sizes
- Angled seat location to secure collet
- Made in USA



Protect & Organize Your Collets!

Collet Series	Collet Capacity	Part Number	Price Each
ER-11	40	SIE-SAER-11-40	\$35.65
ER-16	40	SIE-SAER-16-40	\$35.65
ER-20	40	SIE-SAER-20-40	\$38.73
ER-25	40	SIE-SAER-25-40	\$38.73
ER-32	40	SIE-SAER-32-40	\$39.97
ER-40	28	SIE-SAER-40-28	\$39.97



ER INCH & METRIC COOLANT COLLETS

- Unique patented design is solid steel construction ensuring longer life
- No discs, plugs or other hardware needed.
- Accu-Collets have rubber plugs
- Maximum pressure of 1000 PSI
- Drill insertion does not need to be longer than the collet length
- Lyndex coolant style ER collets feature a unique patented design which staggers the slots to prevent coolant from reaching the face of the collet



Accu-Collets



Note: ER coolant collets are designed for use with cylindrical shank tools (no flats). Use of coolant collets with tools that are not cylindrical will result in coolant leakage.

Nominal I.D. (OD)		L		Max. Runout	
mm	Inch	mm	Inch	mm	Inch
4 - 6	.1575"-.2362"	16	.6299"	0.010	.0004"
6 - 10	.2362"-.3937"	25	.9842"		
10 - 18	.3937"-.7086"	40	1.5748"	0.015	.0006"
18 - 26	.7086"-1.0236"	50	1.9685"		

Frac	MM	Dec.	ER 11 Coolant Collets		ER 16 Coolant Collets	
			Accu-Collets [E]	Lyndex [B]	Accu-Collets [E]	Lyndex [B]
-	3.0	0.1180	\$29.00 ea	\$64.68 ea	\$30.50 ea	\$57.00 ea
1/8	-	0.1250	11-0118-3.0C	-	16-0118-3.0C	-
-	3.5	0.1380	11-0125-1/8C	-	16-0125-1/8C	16-0125-1/8CL
9/64	-	0.1400	11-0138-3.5C	-	16-0138-3.5C	-
5/32	-	0.1560	11-0140-9/64C	-	16-0140-9/64C	16-0140-9/64CL
-	4.0	0.1570	11-0156-5/32C	-	16-0156-5/32C	16-0156-5/32CL
11/64	-	0.1710	11-0157-4.0C	11-0157-4.0CL	16-0157-4.0C	16-0157-4.0CL
-	4.5	0.1770	11-0171-11/64C	-	16-0171-11/64C	-
3/16	-	0.1870	11-0177-4.5C	11-0177-4.5CL	16-0177-4.5C	16-0177-4.5CL
-	5.0	0.1960	11-0187-3/16C	11-0187-3/16CL	16-0187-3/16C	16-0187-3/16CL
13/64	-	0.2030	11-0196-5.0C	11-0196-5.0CL	16-0196-5.0C	16-0196-5.0CL
-	5.5	0.2170	11-0203-13/64C	11-0203-13/64CL	16-0203-13/64C	16-0203-13/64CL
7/32	-	0.2180	11-0217-5.5C	11-0217-5.5CL	16-0217-5.5C	16-0217-5.5CL
15/64	-	0.2340	11-0218-7/32C	11-0218-7/32CL	16-0218-7/32C	16-0218-7/32CL
-	6.0	0.2360	11-0234-15/64C	11-0234-15/64CL	16-0234-15/64C	16-0234-15/64CL
1/4	-	0.2500	11-0236-6.0C	11-0236-6.0CL	16-0236-6.0C	16-0236-6.0CL
-	6.5	0.2560	11-0250-1/4C	11-0250-1/4CL	16-0250-1/4C	16-0250-1/4CL
17/64	-	0.2650	11-0256-6.5C	11-0256-6.5CL	16-0256-6.5C	16-0256-6.5CL
-	7.0	0.2750	11-0265-17/64C	11-0265-17/64CL	16-0265-17/64C	16-0265-17/64CL
9/32	-	0.2812	11-0275-7.0C	11-0275-7.0CL	16-0275-7.0C	16-0275-7.0CL
-	7.5	0.2953	-	-	16-0281-9/32C	16-0281-9/32CL
19/64	-	0.2969	-	-	16-0295-7.5C	16-0295-7.5CL
5/16	-	0.3125	-	-	16-0296-19/64C	16-0296-19/64CL
-	8.0	0.3150	-	-	16-0312-5/16C	16-0312-5/16CL
21/64	-	0.3281	-	-	16-0315-8.0C	16-0315-8.0CL
-	8.5	0.3346	-	-	16-0328-21/64C	16-0328-21/64CL
11/32	-	0.3438	-	-	16-0334-8.5C	16-0334-8.5CL
-	9.0	0.3543	-	-	16-0343-11/32C	16-0343-11/32CL
23/64	-	0.3594	-	-	16-0354-9.0C	16-0354-9.0CL
-	9.5	0.3740	-	-	16-0359-23/64C	16-0359-23/64CL
3/8	-	0.3750	-	-	16-0374-9.5C	16-0374-9.5CL
25/64	-	0.3906	-	-	16-0375-3/8C	16-0375-3/8CL
-	10.0	0.3937	-	-	16-0390-25/64C	16-0390-25/64CL
					16-0393-10.0C	16-0393-10.0CL

Call Us Today For All Of Your Machine Tool Needs!

ER COOLANT COLLETS

ER INCH & METRIC COOLANT COLLETS

FEATURES:

- Unique patented design is solid steel construction ensuring longer life
- No discs, plugs or other hardware needed
- Accu-Collets have rubber plugs
- Maximum pressure of 1000 PSI
- Drill insertion does not need to be longer than the collet length
- Lyndex coolant style ER collets feature a unique patented design which staggers the slots to prevent coolant from reaching the face of the collet



Accu-Collets E

LYNDEX B

Note: ER coolant collets are designed for use with cylindrical shank tools (no flats). Use of coolant collets with tools that are not cylindrical will result in coolant leakage.

Frac	MM	Dec.	ER 20 Coolant Collets		ER 25 Coolant Collets		ER 32 Coolant Collets		ER 40 Coolant Collets	
			Accu-Collets	Lyndex	Accu-Collets	Lyndex	Accu-Collets	Lyndex	Accu-Collets	Lyndex
-	3.0	0.1180	20-0118-3.0C	-	25-0118-3.0C	-	32-0118-3.0C	-	-	-
1/8	-	0.1250	20-0125-1/8C	-	25-0125-01/8C	-	32-0125-1/8C	-	-	-
5/32	-	0.1560	20-0156-5/32C	-	25-0156-5/32C	-	32-0156-5/32C	-	40-0156-5/32C	-
-	4.0	0.1570	20-0157-4.0C	-	25-0157-4.0C	-	32-0157-4.0C	-	40-0157-4.0C	-
3/16	-	0.1870	20-0187-3/16C	-	25-0187-3/16C	-	32-0187-3/16C	-	40-0187-3/16C	-
-	5.0	0.1960	20-0196-5.0C	20-0196-5.0CL	25-0196-5.0C	-	32-0196-5.0C	-	40-0196-5.0C	-
7/32	-	0.2180	20-0218-7/32C	20-0218-7/32CL	25-0218-7/32C	25-0218-7/32CL	32-0218-7/32C	-	40-0218-7/32C	-
-	6.0	0.2360	20-0236-6.0C	20-0236-6.0CL	25-0236-6.0C	25-0236-6.0CL	32-0236-6.0C	-	40-0236-6.0C	-
1/4	-	0.2500	20-0250-1/4C	20-0250-1/4CL	25-0250-1/4C	25-0250-1/4CL	32-0250-1/4C	32-0250-1/4CL	40-0250-1/4C	-
-	7.0	0.2750	20-0275-7.0C	20-0275-7.0CL	25-0275-7.0C	25-0275-7.0CL	32-0275-7.0C	-	40-0275-7.0C	-
9/32	-	0.2810	20-0281-9/32C	20-0281-9/32CL	25-0281-9/32C	25-0281-9/32CL	32-0281-9/32C	32-0281-9/32CL	40-0281-9/32C	-
5/16	-	0.3120	20-0312-5/16C	20-0312-5/16CL	25-0312-5/16C	25-0312-5/16CL	32-0312-5/16C	32-0312-5/16CL	40-0312-5/16C	-
-	8.0	0.3150	20-0315-8.0C	20-0315-8.0CL	25-0315-8.0C	25-0315-8.0CL	32-0315-8.0C	-	40-0315-8.0C	-
11/32	-	0.3430	20-0343-11/32C	20-0343-11/32CL	25-0343-11/32C	25-0343-11/32CL	32-0343-11/32C	32-0343-11/32CL	40-0343-11/32C	-
-	9.0	0.3540	20-0354-9.0C	20-0354-9.0CL	25-0354-9.0C	25-0354-9.0CL	32-0354-9.0C	-	40-0354-9.0C	-
3/8	-	0.3750	20-0375-3/8C	20-0375-3/8CL	25-0375-3/8C	25-0375-3/8CL	32-0375-3/8C	32-0375-3/8CL	40-0375-3/8C	-
-	10.0	0.3930	20-0393-10.0C	20-0393-10.0CL	25-0393-10.0C	25-0393-10.0CL	32-0393-10.0C	32-0393-10.0CL	40-0393-10.0C	40-0393-10.0CL
13/32	-	0.4060	20-0406-13/32C	20-0406-13/32CL	25-0406-13/32C	25-0406-13/32CL	32-0406-13/32C	32-0406-13/32CL	40-0406-13/32C	-
-	11.0	0.4330	20-0433-11.0C	20-0433-11.0CL	25-0433-11.0C	25-0433-11.0CL	32-0433-11.0C	32-0433-11.0CL	40-0433-11.0C	40-0433-11.0CL
7/16	-	0.4370	20-0437-7/16C	20-0437-7/16CL	25-0437-7/16C	25-0437-7/16CL	32-0437-7/16C	32-0437-7/16CL	40-0437-7/16C	-
15/32	-	0.4680	20-0468-15/32C	20-0468-15/32CL	25-0468-15/32C	25-0468-15/32CL	32-0468-15/32C	32-0468-15/32CL	40-0468-15/32C	-
-	12.0	0.4720	20-0472-12.0C	20-0472-12.0CL	25-0472-12.0C	25-0472-12.0CL	32-0472-12.0C	32-0472-12.0CL	40-0472-12.0C	40-0472-12.0CL
1/2	-	0.5000	20-0500-1/2C	20-0500-1/2CL	25-0500-1/2C	25-0500-1/2CL	32-0500-1/2C	32-0500-1/2CL	40-0500-1/2C	-
-	13.0	0.5110	20-0511-13.0C	20-0511-13.0CL	25-0511-13.0C	25-0511-13.0CL	32-0511-13.0C	32-0511-13.0CL	40-0511-13.0C	40-0511-13.0CL
17/32	-	0.5310	-	-	25-0531-17/32C	25-0531-17/32CL	32-0531-17/32C	32-0531-17/32CL	40-0531-17/32C	-
-	14.0	0.5510	-	-	25-0551-14.0C	25-0551-14.0CL	32-0551-14.0C	32-0551-14.0CL	40-0551-14.0C	40-0551-14.0CL
9/16	-	0.5620	-	-	25-0562-9/16C	25-0562-9/16CL	32-0562-9/16C	32-0562-9/16CL	40-0562-9/16C	-
-	15.0	0.5900	-	-	25-0590-15.0C	25-0590-15.0CL	32-0590-15.0C	32-0590-15.0CL	40-0590-15.0C	40-0590-15.0CL
19/32	-	0.5930	-	-	25-0593-19/32C	25-0593-19/32CL	32-0593-19/32C	32-0593-19/32CL	40-0593-19/32C	-
5/8	-	0.6250	-	-	25-0625-5/8C	25-0625-5/8CL	32-0625-5/8C	32-0625-5/8CL	40-0625-5/8C	-
-	16.0	0.6300	-	-	25-0630-16.0C	25-0630-16.0CL	32-0630-16.0C	32-0630-16.0CL	40-0630-16.0C	40-0630-16.0CL
21/32	-	0.6560	-	-	-	-	32-0656-21/32C	32-0656-21/32CL	40-0656-21/32C	-
-	17.0	0.6690	-	-	-	-	32-0669-17.0C	32-0669-17.0CL	40-0669-17.0C	40-0669-17.0CL
11/16	-	0.6870	-	-	-	-	32-0687-11/16C	32-0687-11/16CL	40-0687-11/16C	-
-	18.0	0.7080	-	-	-	-	32-0708-18.0C	32-0708-18.0CL	40-0708-18.0C	40-0708-18.0CL
23/32	-	0.7180	-	-	-	-	32-0718-23/32C	32-0718-23/32CL	40-0718-23/32C	-
-	19.0	0.7480	-	-	-	-	32-0748-19.0C	32-0748-19.0CL	40-0748-19.0C	40-0748-19.0CL
3/4	-	0.7500	-	-	-	-	32-0750-3/4C	32-0750-3/4CL	40-0750-3/4C	-
25/32	-	0.7810	-	-	-	-	32-0781-25/32C	32-0781-25/32CL	40-0781-25/32C	-
-	20.0	0.7870	-	-	-	-	32-0787-20.0C	32-0787-20.0CL	40-0787-20.0C	40-0787-20.0CL
13/16	-	0.8120	-	-	-	-	-	-	40-0812-13/16C	-
-	21.0	0.8260	-	-	-	-	-	-	40-0826-21.0C	40-0826-21.0CL
27/32	-	0.8430	-	-	-	-	-	-	40-0843-27/32C	-
-	22.0	0.8660	-	-	-	-	-	-	40-0866-22.0C	40-0866-22.0CL
7/8	-	0.8750	-	-	-	-	-	-	40-0875-7/8C	-
-	23.0	0.9050	-	-	-	-	-	-	40-0905-23.0C	40-0905-23.0CL
29/32	-	0.9060	-	-	-	-	-	-	40-0906-29/32C	-
15/16	-	0.9370	-	-	-	-	-	-	40-0937-15/16C	-
-	24.0	0.9440	-	-	-	-	-	-	40-0944-24.0C	40-0944-24.0CL
31/32	-	0.9680	-	-	-	-	-	-	40-0968-31/32C	-
-	25.0	0.9840	-	-	-	-	-	-	40-0984-25.0C	40-0984-25.0CL
1	-	1.0000	-	-	-	-	-	-	40-1000-1-INC	-
-	26.0	1.0236	-	-	-	-	-	-	40-1024-26.0C	40-1024-26.0CL

LATHE CHUCKS
LIVE CENTERS

WISE JAWS
WISE ACCESSORIES

STRAIGHT SHANK
COLLET HOLDERS

TAP HOLDERS
DRILL CHUCKS

CARBIDE INSERTS
THREADING/GROOVING

CUTTING TOOLS
MACHINERY

PRECISION TOOLS
DEBURRING

COOLANT/FLUIDS
TOOL STORAGE

Call Us Or Visit Our Website For Our Complete Selection!

ER COOLANT & TAPPING COLLETS

ER COOLANT COLLETS Steel Sealed Precision



- Designed for use with "on-size" tools
- Sealed to 2000 PSI
- No plugs
- Protects tool holder from contaminants
- Use with standard ER collet nuts
- Metric sizes also available



		ER 16	ER 20	ER 25	ER 32	ER 40
Dia	Dec.	\$44.00 ea	\$49.00 ea	\$49.00 ea	\$44.00 ea	\$44.00 ea
3/32"	0.093	16-0093-3/32C-T	-	-	-	-
1/8"	0.125	16-0125-1/8C-T	-	-	-	-
5/32"	0.156	16-0156-5/32CT	20-0156-5/32CT	-	-	-
3/16"	0.187	16-0187-3/16CT	20-0187-3/16CT	-	-	-
7/32"	0.218	16-0218-7/32CT	20-0218-7/32CT	25-0218-7/32CT	32-0218-7/32CT	-
1/4"	0.250	16-0250-1/4CT	20-0250-1/4CT	25-0250-1/4CT	32-0250-1/4CT	-
9/32"	0.281	16-0281-9/32CT	20-0281-9/32CT	25-0281-9/32CT	32-0281-9/32CT	-
5/16"	0.312	16-0312-5/16CT	20-0312-5/16CT	25-0312-5/16CT	32-0312-5/16CT	-
11/32"	0.343	16-0343-11/32CT	20-0343-11/32CT	25-0343-11/32CT	32-0343-11/32CT	-
3/8"	0.375	16-0375-3/8CT	20-0375-3/8CT	25-0375-3/8CT	32-0375-3/8CT	40-0375-3/8CT
13/32"	0.406	16-0406-13/32CT	20-0406-13/32CT	25-0406-13/32CT	32-0406-13/32CT	40-0406-13/32CT
7/16"	0.437	-	20-0437-7/16CT	25-0437-7/16CT	32-0437-7/16CT	40-0437-7/16CT
15/32"	0.468	-	20-0468-15/32CT	25-0468-15/32CT	32-0468-15/32CT	40-0468-15/32CT
1/2"	0.500	-	20-0500-1/2CT	25-0500-1/2CT	32-0500-1/2CT	40-0500-1/2CT
17/32"	0.531	-	-	25-0531-17/32CT	32-0531-17/32CT	40-0531-17/32CT
9/16"	0.562	-	-	25-0562-9/16CT	32-0562-9/16CT	40-0562-9/16CT
19/32"	0.593	-	-	25-0593-19/32CT	32-0593-19/32CT	40-0593-19/32CT
5/8"	0.625	-	-	25-0625-5/8CT	32-0625-5/8CT	40-0625-5/8CT
21/32"	0.656	-	-	-	32-0656-21/32CT	40-0656-21/32CT
11/16"	0.687	-	-	-	32-0687-11/16CT	40-0687-11/16CT
23/32"	0.718	-	-	-	32-0718-23/32CT	40-0718-23/32CT
3/4"	0.750	-	-	-	32-0750-3/4CT	40-0750-3/4CT
7/8"	0.875	-	-	-	-	40-0875-7/8CT
1.0"	1.000	-	-	-	-	40-1000-1CT

ER TAP COLLETS FOR RIGID TAPPING

These collets feature a unique design that uses an internal square drive with our ER series collets. The square drives match the tap square, providing a tight fit for all rigid tapping applications. Using ER tap collets and a standard ER collet chuck allows you to vary the gage length of your tapping application without the need for special tapholders.



ANSI Standard			ER 11	ER 16 Tap Collets		ER 20 Tap Collets	
Tap Size	Shank Size	Square Size	AccuCollets	AccuCollets	Lyndex	AccuCollets	Lyndex
#0 - 6	0.141	0.110	\$33.00 ea	\$33.00 ea	\$74.48 ea	\$33.00 ea	\$81.05 ea
#8	0.168	0.131	11-141-RA-AC	16-141-RA-AC	-	20-141-RA-AC	20-141-RA-LY
#10	0.194	0.152	11-168-RA-AC	16-168-RA-AC	16-168-RA-LY	20-168-RA-AC	20-168-RA-LY
#12	0.220	0.165	11-194-RA-AC	16-194-RA-AC	16-194-RA-LY	20-194-RA-AC	20-194-RA-LY
1/4	0.255	0.191	11-220-RA-AC	16-220-RA-AC	16-220-RA-LY	20-220-RA-AC	20-220-RA-LY
5/16	0.318	0.238	11-255-RA-AC	16-255-RA-AC	16-255-RA-LY	20-255-RA-AC	20-255-RA-LY
3/8	0.381	0.286	16-318-RA-AC	16-318-RA-AC	-	20-318-RA-AC	20-318-RA-LY
7/16	0.323	0.242	-	-	-	20-381-RA-AC	20-381-RA-LY
1/2	0.367	0.275	-	-	-	20-323-RA-AC	20-323-RA-LY
			-	-	-	20-367-RA-AC	20-367-RA-LY

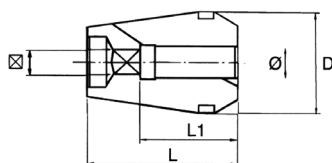

	ER-16	ER-20	ER-25
D	16.0mm	20.0mm	25.0mm
L	27.5mm	31.5mm	34.0mm

	ER-32	ER-40
D	32.0mm	40.0mm
L	40.0mm	46.0mm

ANSI Standard			ER 25 Tap Collets		ER 32 Tap Collets		ER 40 Tap Collets	
Tap Size	Shank Size	Square Size	AccuCollets	Lyndex	AccuCollets	Lyndex	AccuCollets	Lyndex
#0 - 6	0.141	0.110	\$36.50 ea	\$83.79 ea	\$38.50 ea	\$89.77 ea	\$43.50 ea	\$112.70 ea
#8	0.168	0.131	25-141-RA-AC	-	32-141-RA-AC	-	40-141-RA-AC	-
#10	0.194	0.152	25-168-RA-AC	-	32-168-RA-AC	-	40-168-RA-AC	-
#12	0.220	0.165	25-194-RA-AC	25-194-RA-LY	32-194-RA-AC	32-194-RA-LY	40-194-RA-AC	-
1/4	0.255	0.191	25-220-RA-AC	25-220-RA-LY	32-220-RA-AC	32-220-RA-LY	40-220-RA-AC	-
5/16	0.318	0.238	25-255-RA-AC	25-255-RA-LY	32-255-RA-AC	32-255-RA-LY	40-255-RA-AC	40-255-RA-LY
3/8	0.381	0.286	25-318-RA-AC	25-318-RA-LY	32-318-RA-AC	32-318-RA-LY	40-318-RA-AC	40-318-RA-LY
7/16	0.323	0.242	25-381-RA-AC	25-381-RA-LY	32-381-RA-AC	32-381-RA-LY	40-381-RA-AC	40-381-RA-LY
1/2	0.367	0.275	25-323-RA-AC	25-323-RA-LY	32-323-RA-AC	32-323-RA-LY	40-323-RA-AC	40-323-RA-LY
9/16	0.429	0.322	25-367-RA-AC	25-367-RA-LY	32-367-RA-AC	32-367-RA-LY	40-367-RA-AC	40-367-RA-LY
5/8	0.480	0.360	25-429-RA-AC	25-429-RA-LY	32-429-RA-AC	32-429-RA-LY	40-429-RA-AC	40-429-RA-LY
11/16	0.542	0.406	25-480-RA-AC	25-480-RA-LY	32-480-RA-AC	32-480-RA-LY	40-480-RA-AC	40-480-RA-LY
3/4	0.590	0.442	-	-	32-542-RA-AC	32-542-RA-LY	40-542-RA-AC	40-542-RA-LY
13/16	0.652	0.489	-	-	32-590-RA-AC	32-590-RA-LY	40-590-RA-AC	40-590-RA-LY
7/8	0.697	0.523	-	-	32-652-RA-AC	32-652-RA-LY	40-652-RA-AC	40-652-RA-LY
15/16	0.760	0.570	-	-	-	-	40-697-RA-AC	40-697-RA-LY
1"	0.800	0.600	-	-	-	-	40-760-RA-AC	40-760-RA-LY
			-	-	-	-	40-800-RA-AC	40-800-RA-LY

Call Us Today For All Of Your Machine Tool Needs!