

HYDRAULIC CHUCKS

- Balanced to 25,000 RPM @ g2.5
- Delivers uniform pressure allowing it to compress equally around the periphery of the cutting tool
- Concentricity of the hydraulic toolholder delivers runout accuracy of 0.00012 inch or less
- Cutter tool life increases because the chip load on each cutting flute is more uniform
- Rigidity plays an important role in predictable tool life as well as runout
- Thru-spindle coolant AD/B style
- Rapid tool change

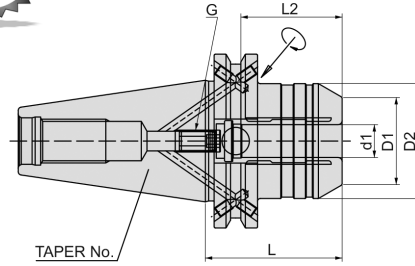

| Taper | ID d1 | D1 | D2 | Proj L | L2 | G | Part Number | Price Each |
|--------|-------|-------|-------|--------|-------|-----------|---------------|------------|
| CAT 40 | 0.500 | 1.260 | 1.654 | 2.520 | 1.457 | M8x1.0mm | C40-50HC252-Y | \$199.00 |
| | 0.625 | 1.362 | 1.752 | 2.520 | 1.654 | M10x1.0mm | C40-62HC252-Y | \$199.00 |
| | 0.750 | 1.512 | 1.752 | 2.520 | 1.654 | M10x1.0mm | C40-75HC252-Y | \$199.00 |
| | 1.000 | 2.244 | 2.598 | 3.500 | 1.890 | M16x1.0mm | C40-10HC350-Y | \$199.00 |
| CAT 50 | 0.500 | 1.879 | 2.752 | 3.189 | 1.457 | M8x1.0mm | C50-50HC318-Y | \$299.00 |
| | 0.625 | 1.811 | 2.752 | 3.189 | 1.654 | M10x1.0mm | C50-62HC318-Y | \$299.00 |
| | 0.750 | 2.185 | 2.752 | 3.189 | 2.165 | M10x1.0mm | C50-75HC318-Y | \$299.00 |
| | 1.000 | 2.185 | 2.752 | 3.189 | 2.165 | M16x1.0mm | C50-10HC318-Y | \$299.00 |
| | 1.250 | 2.185 | 2.752 | 3.189 | 2.165 | M16x1.0mm | C50-12HC318-Y | \$299.00 |

HYDRAULIC CHUCK COLLETS

- Reduction sleeve adapts tool shank sizes that cannot be directly clamped in holder
- Increases flexibility of toolholder
- Assemble cutting tool with collet first, then insert collet into hydraulic chuck

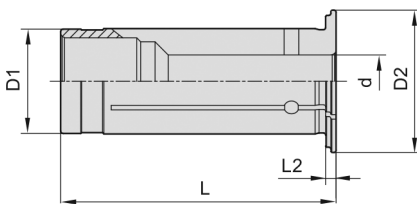

| TYPE | ID d | OD D1 | D2 | OAL L | L2 | Part Number | Price Each |
|----------|------|-------|-------|-------|-------|-------------|------------|
| HK 1/2 | 1/8 | 0.500 | 0.748 | 1.850 | 0.079 | YG-HC612108 | \$124.01 |
| | 3/16 | 0.500 | 0.748 | 1.850 | 0.079 | YG-HC612316 | \$124.01 |
| | 1/4 | 0.500 | 0.748 | 1.850 | 0.079 | YG-HC612104 | \$124.01 |
| | 5/16 | 0.500 | 0.748 | 1.850 | 0.079 | YG-HC612516 | \$124.01 |
| HK 3/4 | 1/8 | 0.750 | 0.945 | 1.988 | 0.079 | YG-HC625108 | \$124.01 |
| | 3/16 | 0.750 | 0.945 | 1.988 | 0.079 | YG-HC625316 | \$124.01 |
| | 1/4 | 0.750 | 0.945 | 1.988 | 0.079 | YG-HC625104 | \$124.01 |
| | 5/16 | 0.750 | 0.945 | 1.988 | 0.079 | YG-HC625516 | \$124.01 |
| | 3/8 | 0.750 | 0.945 | 1.988 | 0.079 | YG-HC625308 | \$124.01 |
| | 1/2 | 0.750 | 0.945 | 1.988 | 0.079 | YG-HC625102 | \$124.01 |
| | 5/8 | 0.750 | 0.945 | 1.988 | 0.079 | YG-HC625508 | \$124.01 |
| | 1/8 | 1.250 | 1.417 | 2.382 | 0.118 | YG-HC632108 | \$124.01 |
| HK 1-1/4 | 3/16 | 1.250 | 1.417 | 2.382 | 0.118 | YG-HC632316 | \$124.01 |
| | 1/4 | 1.250 | 1.417 | 2.382 | 0.118 | YG-HC632104 | \$124.01 |
| | 5/16 | 1.250 | 1.417 | 2.382 | 0.118 | YG-HC632516 | \$124.01 |
| | 3/8 | 1.250 | 1.417 | 2.382 | 0.118 | YG-HC632308 | \$124.01 |
| | 1/2 | 1.250 | 1.417 | 2.382 | 0.118 | YG-HC632102 | \$124.01 |
| | 5/8 | 1.250 | 1.417 | 2.382 | 0.118 | YG-HC632508 | \$124.01 |
| | 3/4 | 1.250 | 1.417 | 2.382 | 0.118 | YG-HC632304 | \$124.01 |
| | 1 | 1.250 | 1.417 | 2.382 | 0.118 | YG-HC632100 | \$124.01 |

PRO-TOUCH OFF GAGE

Accurately Establish Tool Length Offsets On CNC Milling Machines!

Set tools accurately with the Pro Touch Off Gage. Decrease set up time and eliminate tool path mismatch. Allows you to standardize the way tool offsets are measured in your shop, ensuring every job is setup the same way and runs without issue. To use, simply lower the tool down onto the contact face until the indicator reads zero. Have confidence that the tool tip is exactly 4 inches from the surface the gage is sitting on



- Large 1" dia stainless steel contact face, lightly spring loaded to protect against overrun
- Offset height 4.000" (101.6mm)
- Large 2.2" easy to read indicator face
- Gage graduations 0.001"
- Gage repeatability 0.0002"
- Body made from red anodized 6061-T6 aluminum
- Easy calibration check using 1-2-3 blocks
- Padded case and manual included

Pro Touch Off Gage
Part # EDGE-52000
\$99.99 ea

Call Us Or Visit Our Website For Our Complete Selection!