

## DIFFERENTIAL SCREWS

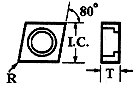

**ICSN**

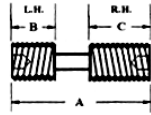
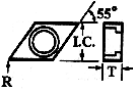

**IDSN**

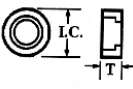

**IRSN**

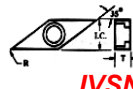

**IVSN**

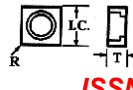

**ISSN**

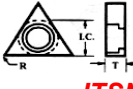

**ITSN**

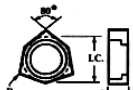

**IWSN**

A	B	C	H	T	Part Number	Price Each
1.16	0.5	0.41	5/32	5/16-24	CS-30	\$1.00
1.38	0.5	0.5	3/16	3/8-24	CS-32	\$3.48
1.16	0.45	0.45	1/8	1/4-28	CS-33	\$1.00
0.59	0.19	0.19	3/32	10-32	CS-35	\$1.00
0.62	0.25	0.25	3/32	10-32	LS-20	\$1.72
0.87	0.25	0.5	3/32	10-32	LS-21	\$1.72
1	0.4	0.4	1/8	1/4-28	LS-30	\$1.00
1.25	0.5	0.53	1/8	1/4-28	LS-33	\$1.86
0.75	0.25	0.25	3/32	10-32	MS-36	\$1.00
0.75	0.31	0.31	1/8	1/4-28	MS-46	\$1.00
0.81	0.28	0.28	1/8	1/4-28	MS-47	\$1.00
1	0.38	0.38	1/8	1/4-28	MS-48	\$1.00
1.12	0.5	0.5	5/32	5/16-24	MS-59	\$1.00
1.25	0.5	0.5	5/32	5/16-24	MS-510	\$1.00
1.38	0.5	0.5	3/16	3/8-24	MS-610	\$1.00
1.16	0.5	0.41	5/32	5/16-24	STC-4	\$1.00
0.84	0.31	0.31	3/32	10-32	STC-5	\$1.00
1	0.5	0.25	5/32	5/16-24	STC-8	\$1.00
0.59	0.19	0.19	3/32	10-32	STC-9	\$1.00
0.81	0.28	0.28	1/8	1/4-28	STC-11	\$1.00
1.38	0.5	0.5	3/16	3/8-24	STC-19	\$1.00
1.16	0.45	0.45	1/8	1/4-28	STC-20	\$1.00
0.69	0.28	0.28	1/8	1/4-28	STC-32	\$1.00
0.75	0.31	0.31	5/64	8-32	XNS-26	\$2.52
0.59	0.22	0.22	3/32	10-32	XNS-35	\$1.00
0.75	0.25	0.25	3/32	10-32	XNS-36	\$1.00
0.84	0.31	0.31	3/32	10-32	XNS-37	\$1.00
1	0.37	0.37	3/32	10-32	XNS-38	\$1.00
0.75	0.31	0.31	1/8	1/4-28	XNS-46	\$1.00
0.81	0.28	0.28	1/8	1/4-28	XNS-47	\$1.00
1	0.37	0.37	1/8	1/4-28	XNS-48	\$1.00
1	0.28	0.5	5/32	5/16-24	XNS-58	\$1.00
1.12	0.41	0.47	5/32	5/16-24	XNS-59	\$1.00
1.25	0.5	0.5	5/32	5/16-24	XNS-510	\$1.00
1.5	0.62	0.62	5/32	5/16-24	XNS-512	\$2.00
1.38	0.5	0.5	3/16	3/8-24	XNS-610	\$2.52

## SHIM SEATS

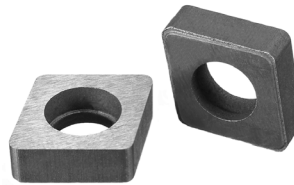

**HARDWARE SOLD IN PACKAGES OF 10**

INSERT I.C.	Thick.	R	Part Number	Price Each
1/2	3/16	1/32	ICSN-432	\$3.90
1/2	3/16	3/64	ICSN-433	\$3.90
5/8	3/16	3/64	ICSN-533	\$4.82
3/4	3/16	3/64	ICSN-633	\$5.56
3/4	1/4	3/64	ICSN-643	\$7.52
1/2	3/16	3/64	IDSN-433	\$3.56
5/8	3/16	3/64	IDSN-533	\$5.38
5/8	1/4	3/64	IDSN-543	\$6.32
3/8	1/8	-	IRSN-32	\$2.98
1/2	3/16	-	IRSN-43	\$3.12
1/2	1/4	-	IRSN-44	\$4.68
5/8	3/16	-	IRSN-53	\$4.98
3/4	3/16	-	IRSN-63	\$5.66
1	1/4	-	IRSN-84	\$11.22
3/8	1/8	1/32	IVSN-322	\$3.16
3/8	1/8	1/16	IVSN-324	\$3.16
1/2	3/16	1/32	IVSN-432	\$4.22
1/2	3/16	3/64	IVSN-433	\$4.22

INSERT I.C.	Thick.	R	Part Number	Price Each
3/8	1/8	1/32	ISSN-322	\$2.42
3/8	1/8	3/64	ISSN-323	\$2.42
1/2	3/16	3/64	ISSN-433	\$3.84
1/2	3/16	1/16	ISSN-434	\$3.84
1/2	1/4	3/64	ISSN-443	\$4.68
5/8	3/16	3/64	ISSN-533	\$4.56
3/4	3/16	3/64	ISSN-633	\$5.38
3/4	1/4	3/64	ISSN-643	\$7.80
3/8	1/8	1/32	ITSN-322	\$2.72
3/8	1/8	3/64	ITSN-323	\$2.72
3/8	3/16	3/64	ITSN-333	\$2.84
1/2	3/16	1/32	ITSN-432	\$4.40
1/2	3/16	3/64	ITSN-433	\$4.40
1/2	3/16	1/16	ITSN-434	\$4.40
1/2	1/4	3/64	ITSN-443	\$6.62
5/8	3/16	3/64	ITSN-533	\$5.66
5/8	3/16	1/16	ITSN-534	\$5.66
3/4	3/16	3/64	ITSN-633	\$10.72
3/4	3/16	3/32	ITSN-636	\$7.68
3/8	1/8	3/64	IWSN-323	\$3.58
1/2	3/16	3/64	IWSN-433	\$4.84

## LOCK PINS



**HARDWARE SOLD IN PACKAGES OF 10**

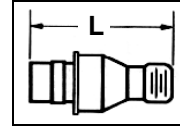

Reference Numbers							
Sandvik Number	Kennametal Number	Insert I.C.	L	H	T	Part Number	Price Each
-	-	5/16	0.32	1/16	8-32	NL-2.52	\$3.96
MN-23	KL-23	1/4	0.32	1/16	8-32	NL-23	\$2.24
MN-33	KL-33	3/8	0.34	5/64	10-32	NL-33	\$2.00
MN-33L	KL-33L	3/8	0.41	5/64	10-32	NL-33L	\$2.00
MN-34	KL-34	3/8	0.45	5/64	10-32	NL-34	\$2.00
MN-34L	KL-34L	3/8	0.51	5/64	10-32	NL-34L	\$2.00
MN-43	-	1/2	0.42	5/64	10-32	NL-43	\$2.00
MN-44	KL-44	1/2	0.51	3/32	1/4-28	NL-44	\$2.00
MN-46	KL-46	1/2	0.67	3/32	1/4-28	NL-46	\$1.84
MN-46L	KL-46L	1/2	0.73	3/32	1/4-28	NL-46L	\$2.00
-	-	5/8	0.64	1/8	5/16-24	NL-55	\$4.74
MN-56	-	5/8	0.7	1/8	5/16-24	NL-56	\$2.24
-	-	5/8	0.81	1/8	5/16-24	NL-57	\$2.24
MN-58	KL-58	5/8	0.86	1/8	5/16-24	NL-58	\$2.00
-	-	5/8	0.89	1/8	5/16-24	NL-58L	\$5.04
MN-66	-	3/4	0.7	9/64	3/8-24	NL-66	\$3.06
MN-66L	-	3/4	0.83	9/64	3/8-24	NL-66L	\$4.38
MN-68	KL-68	3/4	0.86	9/64	3/8-24	NL-68	\$2.24
MN-68L	KL-68L	3/4	0.95	9/64	3/8-24	NL-68L	\$2.24
-	-	1	0.94	5/32	7/16-20	NL-808	\$8.36
MN-810	-	1	1.17	5/32	7/16-20	NL-810	\$5.04
-	-	1 1/2	1.17	7/32	9/16-18	NL-1010	\$13.98

## CLAMPS

**HARDWARE SOLD IN PACKAGES OF 10**

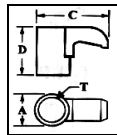

CLAMP REFERENCE NUMBERS								
Sandvik	Kennametal	Valenite	A	C	D	T	Part Number	Price Each
-	-	-	0.28	0.52	0.35	10-32	CL-5	\$3.56
MC-6	CK-6	CLI-6	0.31	0.58	0.44	10-32	CL-6	\$3.56
-	-	CLI-7	0.31	0.64	0.31	10-32	CL-7	\$3.56
MC-9	CK-9	CLI-9	0.43	0.75	0.66	5/16-24	CL-9	\$3.56
MC-12	CK-12	CLI-12	0.43	0.88	0.66	5/16-24	CL-12	\$3.56
MC-19	CK-19	CLI-19	0.31	0.55	0.31	10-32	CL-19	\$4.46
MC-20	CK-20	CLI-20	0.37	0.73	0.38	1/4-28	CL-20	\$3.56
-	-	-	0.37	0.73	0.53	1/4-28	CL-21	\$9.30
-	-	-	0.37	0.85	0.53	1/4-28	CL-22	\$9.96
-	-	CLI-24	0.49	1	0.78	3/8-24	CL-24	\$6.28
MC-30	CK-30	CLI-30	0.43	1	0.66	5/16-24	CL-30	\$6.28
MC-9	-	-	0.43	0.75	0.66	5/16-24	CL-41	\$3.56
MC-12	-	-	0.43	0.88	0.66	5/16-24	CL-42	\$3.56
-	-	-	0.37	0.73	0.53	1/4-28	CL-43	\$9.30
-	-	-	0.37	0.85	0.53	1/4-28	CL-44	\$9.30
-	-	-	0.49	1	0.78	3/8-24	CL-45	\$7.78
-	-	-	0.43	1	0.66	5/16-24	CL-46	\$8.36
-	-	-	0.31	0.64	0.31	10-32	CL-48	\$4.80

Call Us Or Visit Our Website For Our Complete Selection!

LATHE CHUCKS  
LIVE CENTERS

WISE JAWS  
WISE ACCESSORIES

STRAIGHT SHANK  
COLLET HOLDERS

TAP HOLDERS  
DRILL CHUCKS

CARBIDE INSERTS  
THREADING/GROOVING

CUTTING TOOLS  
MACHINERY

PRECISION TOOLS  
DEBURRING

COOLANT/FLUIDS  
TOOL STORAGE